

Accessories



Power distribution

7/70

DLM modular chassis

7/70

DL modular chassis

7/72

Single-chassis coupling set

7/75

Double-chassis coupling set

7/76

Chassis-coupling set with zone for busbars

7/77

Cover plates

7/78

Set of fixed rail

7/81

Reinforced plate supports

7/83

Cable duct fixing supports

7/84

Busbars and blocks

7/85

Busbars support accessories

7/91

Sigma safety terminals

7/96

Terminals

7/97

Earthing strips

7/98

7

Power distribution

Modular distribution



For ranges
CRN, S3X, S3D

DLM modular chassis

- The chassis consists of metal cut-out front panels, which can be clipped on without screws, structured finish, epoxy-polyester powder, RAL-7035 grey, on a rigid galvanised-steel structure.
- The depth of the chassis can be adjusted from 40 to 85 mm, between the rail and the front panel, allowing the installation of all types of devices.

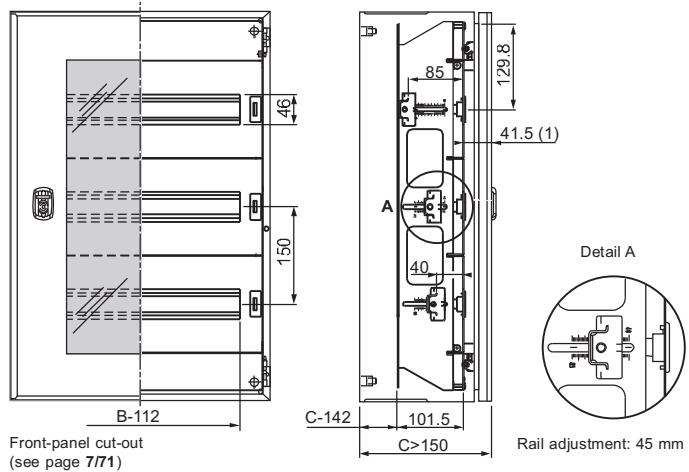

7

Dimensions (mm)		Number of modules*	Modular chassis reference	Plain front plate reference	Plain chassis reference
Height	Width				
400	300	24	NSYDLM24	NSYCTL300DLM	NSYPMP300DLM
500	400	48	NSYDLM48	NSYCTL400DLM	NSYPMP400DLM
600	400	48	NSYDLM48P	NSYCTL400DLM	NSYPMP400DLM
600	600	84	NSYDLM66	NSYCTL500DLM	NSYPMP600DLM
700	500	66	NSYDLM84	NSYCTL500DLM	NSYPMP500DLM
700	500	88	NSYDLM88	NSYCTL500DLM	NSYPMP500DLM
800	600	84	NSYDLM84P	NSYCTL600DLM	NSYPMP600DLM
800	600	112	NSYDLM112	NSYCTL600DLM	NSYPMP600DLM
1000	600	168	NSYDLM168	NSYCTL600DLM	NSYPMP600DLM
1000	800	234	NSYDLM240	NSYCTL800DLM	NSYPMP800DLM

* 1 module = 2 steps = 18 mm.

Power distribution

Modular distribution

Number of modules per chassis in steps of 18 mm



Chassis reference	NSYDLM24	NSYDLM48	NSYDLM48P	NSYDLM84	NSYDLM66	NSYDLM88	NSYDLM84P	NSYDLM112	NSYDLM168	NSYDLM240
Enclosure height (mm)	400	500	600	600	700	700	800	800	1000	1000
Enclosure width (mm)	300	400	400	600	500	500	600	600	600	800
Number of rows	2	3	3	3	3	4	3	4	6	6
Modules per row	12	16	16	28	22	22	28	28	28	39
Total n. of modules	24	48	48	84	66	88	84	112	168	234

*For references **NSYDLM48**, **NSYDLM48P** and **NSYDLM84** on Special wall-mounting enclosures the central row can only receive modules at the height of the lock when installed at the front of the enclosure. In this case, 1 module is sealed up (check our technical instructions).



Plain front panel

- Metal front panels to be clipped on without screws, structured finish, 100% polyester powder, RAL-7035 grey colour.
- Nominal height: 150 mm.



Composition: 2 plain front panel and fixings.

Enclosure width (mm)	No. of modules	Reference
300	12	NSYCTL300DLM
400	16	NSYCTL400DLM
500	22	NSYCTL500DLM
600	28	NSYCTL600DLM
800	40	NSYATP6DTM



Plain mounting plate

- Mounting plate for fixing non-modular devices.
- Material: galvanised steel, 2 mm thick.
- Nominal height: 150 mm.
- To be ordered in multiples of 2 parts.



Composition: 2 plain chassis and fixings.

Enclosure width (mm)	A (mm)	Reference
300	208	NSYPMP300DLM
400	308	NSYPMP400DLM
500	408	NSYPMP500DLM
600	508	NSYPMP600DLM
800	708	NSYPMP800DLM

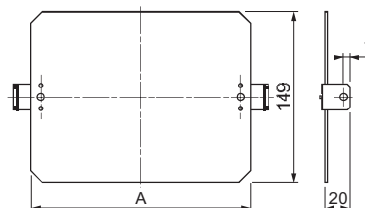

Sheet, 2 mm thick

7

Power distribution

Modular distribution



NSYCRN64150P + NSYDLCR64

For ranges
CRN, S3X, S3D*

DL modular chassis

Dinimel chassis designed for devices with heights of 53 and 68 mm, which can be coupled directly to the enclosure plate-support bolts. Manufactured from sheet steel. Metal protective cover plate, RAL-7035 colour.

- Distance between device rail and protective cover plate: 45 mm.

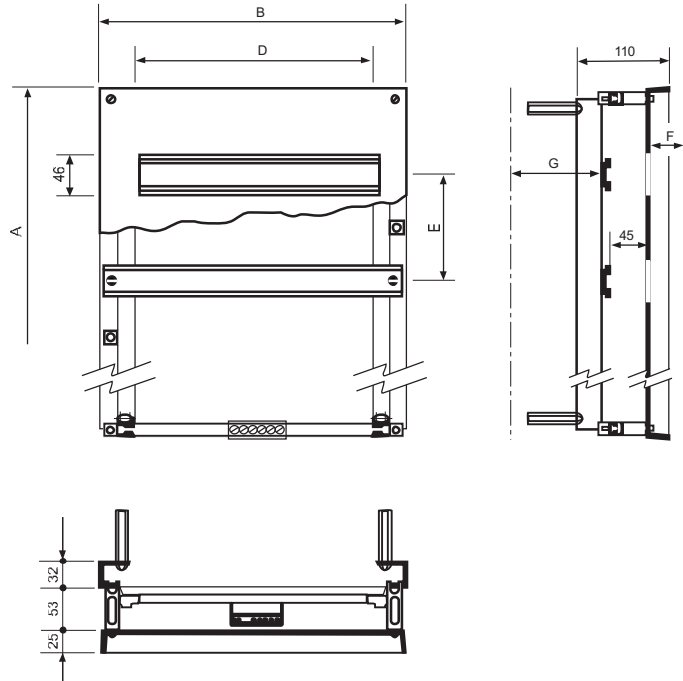

*For Spacial S3D please consult us.

Dimension F: Distance from the protective cover plate to the inside of the door.
Dimension G: Distance from the device-support rail to the rear of the enclosure.

7

Reference	No. of 18-mm modules	No. of rows	Approx. weight (kg)	For coupling to the enclosures with normal or transparent door			Dimensions (mm)					
				Height	Width	Depth	A	B	D	E	F**	G
NSYDLCR18	18	2	1.2	300	250	150*	255	205	162	120	41	51
NSYDLCR24	24	2	1.7	400	300	150*	355	255	216	160	41	51
NSYDLCR36	36	3	1.7	400	300	150*	355	255	216	110	41	51
NSYDLCR48	48	3	2.4	500	400	150*	455	355	288	130	41	51
NSYDLCR64	64	4	3.3	600	400	150/200	555	355	288	130	41	51/101
NSYDLCR88	88	4	4.5	600	500	150/200	555	455	396	130	41	51/101
NSYDLCR110	110	5	5.1	700	500	200	655	455	396	125	41	101
NSYDLCR135	135	5	7.5	800	600	200	755	555	486	140	41	101

* For coupling to enclosures with a depth of 200 mm, the stand-offs (ref. NSYEX608) are to be ordered separately (4 per chassis).

** For enclosures with transparent door, the F dimension is reduced by 4 mm.



See also the accessories



Plain front plates page 7/71



Blanking plate page 7/73

Power distribution

Modular distribution



Blanking plate

Blanking plate made from fire-proof insulating material, for full or partial covering of the circuit-breaker windows; it can easily be cut to the required size.

Length (mm)	N° of modules	RAL	Reference
72	4	7032	NSYATP72G
72	4	7035	NSYATP72MS
108	6	-	NSYATP6DTM
432	24	-	NSYATP24DTM
1100	-	7032	NSYATPUND



See also
the accessories



Connecting strips
page 7/98

Power distribution

Modular distribution



Modular distribution system

- The modular distribution system is made up of a range of accessories prepared for forming electric panels with high distribution capacity.
- The accessories are installed on a chassis mounted at the front of the enclosure, such as for example:
 - Cover plates for enclosures with widths of 600 and 800, solid or cut-out in screwed-on or hinged versions. They cover 24 or 36 modules per row, depending on the width of the enclosure.
 - Material support rails, fixed or with adjustable depth.
 - Chassis supports for coupling non-modular equipment.
 - Supports for fixing cable-distribution cable ducts.
- Sets of accessories made up of material-supporting frames with chassis and cover plates are offered for the construction of double or busbar modular chassis. All the accessories of the individual chassis system can also be combined in the same way with the double chassis or with the chassis with busbar area.

Modular distribution accessories

- Schneider Electric has developed a broad range of accessories for the construction of modular distribution frames, meeting the needs of the market.
- The new range has a coupling chassis, installed at the front of the enclosure, allowing the installation of:
 - Cover plates with lengths of 600 and 800 mm, plain and cut-out, screwed on and hinged, with heights of 150, 200, 300, 400, 450 and 600 mm.
 - Material support rails, fixed or with adjustable depth.
 - Mounting plate supports, plain or perforated, for installation of non-modular devices.

[For ranges SF, SM]

7

- For the construction of double modular distribution frames or with busbar chamber, specific coupling chassis have been created for these applications.



Power distribution

Modular distribution



Single-chassis coupling set

- Chassis made up of vertical uprights and horizontal crossbars:
 - **Spacial SF**: they are screwed to the front frame of the enclosure.
 - **Spacial SM**: they are screwed to the front frame of the enclosure by means of the vertical adaptation profiles, see page 7/34.
- Easy access to the inside for component installation.
- Material: steel.
- Finish: painted with epoxy-polyester resin, textured RAL-7035 grey.

 Supply: two vertical uprights, two horizontal crossbars and fixing elements.

Nominal dimensions (mm)		Maximum no. of 18-mm modules	Reference
Height (A)	Width (B)		
1200	600	144	NSYCSH126
	800	216	NSYCSH128
1400	600	192	NSYCSH146
	800	288	NSYCSH148
1600	600	216	NSYCSH166
	800	324	NSYCSH168
1800	600	240	NSYCSH186
	800	360	NSYCSH188
2000	600	288	NSYCSH206
	800	432	NSYCSH208

[For ranges SF, SM]

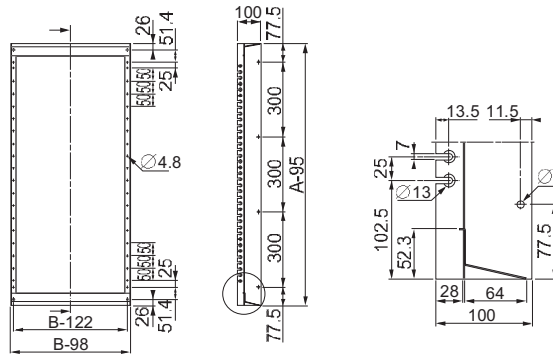

Example of the combination of cut-out, screwed-on cover plates and single-chassis coupling set

Nominal dimensions (mm)		No. of 18-mm modules	Reference		
Height (A)	Width (B)		1 single-chassis coupling set	5 screwed-on cut-out cover plates	2 adjustment cover plates
1800	600	240	1 × NSYCSH186	5 × NSYMUC306	1 × NSYADC16

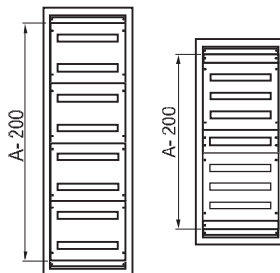

Power distribution

Modular distribution

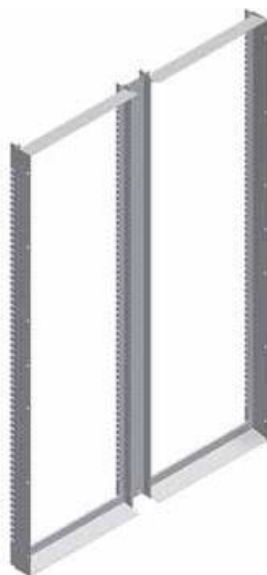

[For ranges SF, SM]

Double-chassis coupling set

- Mounting on enclosures with widths of 1200 and 1600 mm.
- Installation on **Spacial SM**: they are screwed to the front frame of the enclosure by means of the vertical adaptation profiles, see page 7/34.
- Set made up of two modular chassis with an intermediate central upright.
- **Spacial SM**: for enclosures with a width of 1200 mm the top/bottom adjustment rails are necessary, see page 7/21.
- **Spacial SF**: the double-door enclosure adaptation kit is required for enclosure widths of 1200 and 1600 mm, see page 7/19.
- Material: steel.
- Finish: painted with epoxy-polyester resin, textured RAL-7035 grey.

 Supply: two single-chassis coupling sets, one intermediate central upright and fixing elements.

Spacial dimensions (mm)		Set made up of columns with a width (mm)	Maximum no. of 18-mm modules	Reference
Height	Width			
1400	1200	600 + 600	384	NSYDCSH1412
1600	1200	600 + 600	432	NSYDCSH1612
	1200	600 + 600	480	NSYDCSH1812
1800	1600	800 + 800	720	NSYDCSH1816
	1200	600 + 600	576	NSYDCSH2012
2000	1600	800 + 800	864	NSYDCSH2016

Example of the combination of cut-out, screwed-on cover plates and double-chassis coupling set

Spacial dimensions (mm)				Reference		
Height (A)	Width (B)	Depth (C)	No. of 18-mm modules	1 double-chassis coupling set	12 screwed-on cut-out 300-mm cover plates	Double-door enclosure adaptation kit
2000	1200	500	576	1 × NSYDCSH2012	12 × NSYMUC306	NSYSMP2D5
	1600	500	864	1 × NSYDCSH2016	12 × NSYMUC308	-

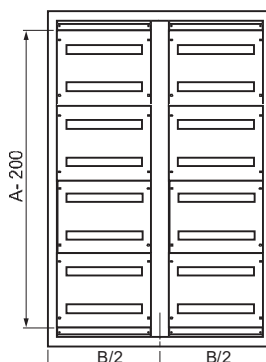

7

Power distribution

Modular distribution

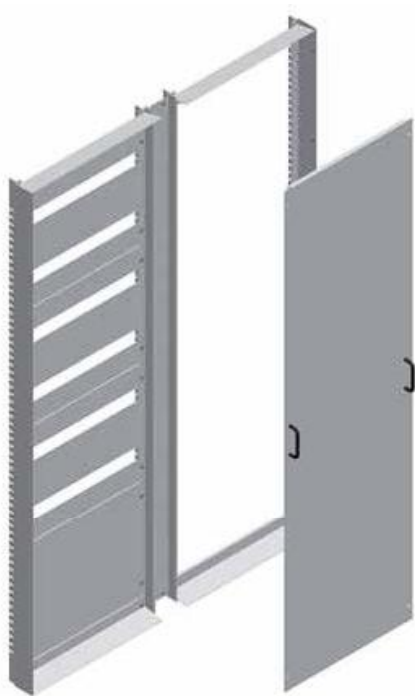

[For ranges SF, SM]

Chassis-coupling set with zone for busbars

- Set for mounting on enclosures with widths of 1000 and 1200 mm.
- **Spacial SF:** They are screwed to the front frame enclosure.
- **Spacial SM:** They are screwed to the front frame of the enclosure by means of the vertical and horizontal adaptation profiles, see page 7/34.
- Assembly made up of a modular chassis with an intermediate central upright and a blanking cover plate for busbars (width 300 mm).
- Material: steel.
- Finish: painted with epoxy-polyester resin, textured RAL-7035 grey.



- Supply:
- One single-chassis coupling set.
 - One intermediate central upright.
 - One busbar blanking cover plate.
 - Fixing elements.

Nominal dimensions (mm)		Set made up of columns with a width (mm)	Maximum no. of 18-mm modules	Reference
Height	Width			
1400	1000	600 + 400	192	NSYCShB1410
	1200	800 + 400	288	NSYCShB1412
1600	1000	600 + 400	216	NSYCShB1610
	1200	800 + 400	324	NSYCShB1612
1800	1000	600 + 400	240	NSYCShB1810
	1200	800 + 400	360	NSYCShB1812
2000	1000	600 + 400	288	NSYCShB2010
	1200	800 + 400	432	NSYCShB2012

Example of the combination of cut-out, screwed-on cover plates and chassis-coupling set with busbar zone

Nominal dimensions (mm)		No. of 18-mm modules	Reference		
Height (A)	Width (B)		1 chassis-coupling set with zone for busbars	5 screwed-on cut-out 300-mm cover plates	2 adjustment cover plates
1800	1000	240	1 × NSYCShB1810	5 × NSYMUC306	1 × NSYADC16
1800	1200	360	1 × NSYCShB1812	5 × NSYMUC308	1 × NSYADC18

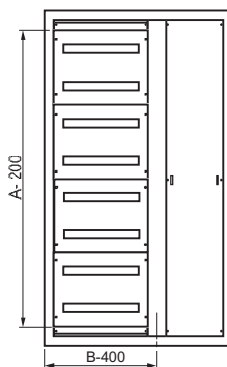

7

Power distribution

Modular distribution

Plain cover plates

- Metal cover plates for protecting control devices.
- The cut-outs in non-modular control devices is at user's request
- Suitable by modules of 150 or 200 mm.
- Versions:
 - Screwed-on plain cover plate.
 - Hinged plain cover plate. 120° opening with flat hinge.
- Material: steel.
- Finish: painted with epoxy-polyester resin, textured RAL-7035 grey.

 Supply: one plain cover plate and fixing elements.



[For ranges SF, SM]



7

Nominal dimensions (mm)		Screwed-on plain cover plate reference	Hinged plain cover plate reference
Height (A)	Width (B)		
150	600	NSYMPC156	NSYMPCH156
	800	NSYMPC158	NSYMPCH158
200	600	NSYMPC206	NSYMPCH206
	800	NSYMPC208	NSYMPCH208
300	600	NSYMPC306	NSYMPCH306
	800	NSYMPC308	NSYMPCH308
400	600	NSYMPC406	NSYMPCH406
	800	NSYMPC408	NSYMPCH408
450	600	NSYMPC456	NSYMPCH456
	800	NSYMPC458	NSYMPCH458
600	600	NSYMPC606	NSYMPCH606
	800	NSYMPC608	NSYMPCH608

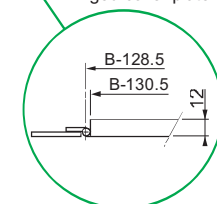
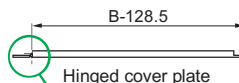
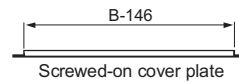
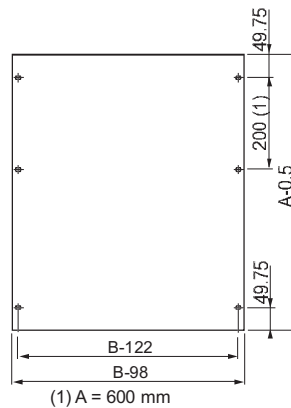

Power distribution

Modular distribution



Cut-out cover plates

- Cut-out metal cover plates for modular switchgear (1 module = 18 mm).
- Suitable by modules of 150 or 200 mm.
- Cover plates for 600-mm enclosures: 24 modules per row.
- Cover plates for 800-mm enclosures: 36 modules per row.
- Versions:
 - Screwed-on cut-out cover plate.
 - Hinged cut-out cover plate. 120° opening with flat hinge.
- Material: steel.
- Finish: painted with epoxy-polyester resin, textured RAL-7035 grey.



Supply: one cut-out cover plate and fixing elements.

Nominal dimensions (mm)		Dimensions			No. of cut-outs	Maximum no. of 18-mm modules	Screwed-on cut-out cover plate reference	Hinged cut-out cover plate reference
Height (A)	Width (B)	D	E	F				
150	600	432	-	-	1	24	NSYMUC156	NSYMUCH156
	800	642	-	-	1	36	NSYMUC158	NSYMUCH158
200	600	432	-	-	1	24	NSYMUC206	NSYMUCH206
	800	642	-	-	1	36	NSYMUC208	NSYMUCH208
300	600	432	51.75	150	2	48	NSYMUC306	NSYMUCH306
	800	642	51.75	150	2	72	NSYMUC308	NSYMUCH308
400	600	432	76.75	200	2	48	NSYMUC406	NSYMUCH406
	800	642	76.75	200	2	72	NSYMUC408	NSYMUCH408
450	600	432	51.75	150	3	72	NSYMUC456	NSYMUCH456
	800	642	51.75	150	3	108	NSYMUC458	NSYMUCH458
600	600	432	76.75	200	3	72	NSYMUC606	NSYMUCH606
	800	642	76.75	200	3	108	NSYMUC608	NSYMUCH608

For ranges SF, SM

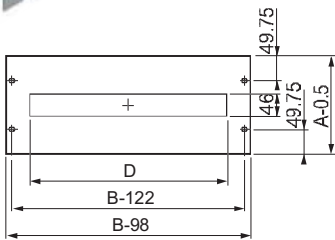

A = 150 and 200 mm

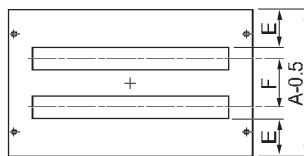

A = 300 and 400 mm

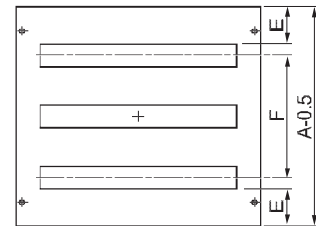

A = 450 and 600 mm

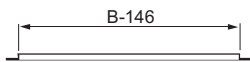

Screwed-on cover plate

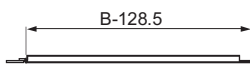

Hinged cover plate

7

Power distribution

Modular distribution



[For ranges
SF, SM]



7

Adjustment cover plates

- Metal adjustment cover plates designed to complete the front of the modular chassis according to the combinations made by modules of 150 or 200 mm.
- Material: steel.
- Finish: painted with epoxy-polyester resin, textured RAL-7035 grey.



Supply: two adjustment cover plates and fixing elements.

Cover plate dimensions (mm)	Nominal dimensions (mm)		Reference
	Height	Width	
50		600	NSYADC16
		800	NSYADC18

Blanking covers

- Blanking covers for cut-out cover plates.
- Each cover is made up of four strips of four modules each (1 module = 18 mm).
- Material: plastic.
- Finish: RAL-7035 grey.



Supply: 25 strips of 4 modules.

Reference
NSYATP72M

Power distribution

Modular distribution



[For ranges SF, SM]

Set of fixed rail with supports

- Set made up of a galvanised symmetric DIN rail, 35 × 15 mm, and fixed mounting supports, for the installation of modular devices or not.
- Maximum number of 18-mm modules:
 - Enclosure width 600 mm: 24 modules.
 - Enclosure width 800 mm: 36 modules.
- Mounting by screws directly on the uprights of the chassis-coupling set.
- Material: zinc-coated steel.

Supply: one DIN rail, two fixed supports and fixing elements.

Nominal dimensions (mm)	Reference
Width (B)	
600	NSYMFSC60
800	NSYMFSC80

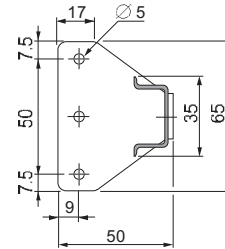
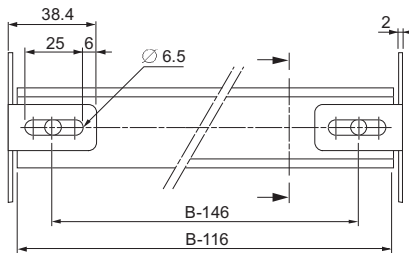

Fixed supports with no rail

Supply: two fixed supports and fixing elements.

Reference
NSYMF51

7

Power distribution

Modular distribution



[For ranges SF, SM]

Set of depth-adjustable rail with supports

- Set made up of a galvanised symmetric DIN rail, 35 × 15 mm, and depth-adjustable mounting supports, for the installation of modular devices or not.
- Maximum number of 18-mm modules:
 - Enclosure width 600 mm: 24 modules.
 - Enclosure width 800 mm: 36 modules.
- Mounting by screws directly on the uprights of the modular chassis-coupling set.
- Material: zinc-coated steel.



Supply: one DIN rail, two adjustable supports and fixing elements.

Nominal dimensions (mm)	Reference
Width (B)	
600	NSYMFSC60D
800	NSYMFSC80D

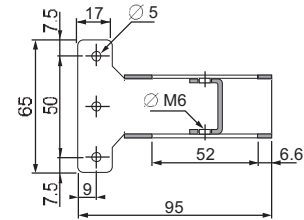
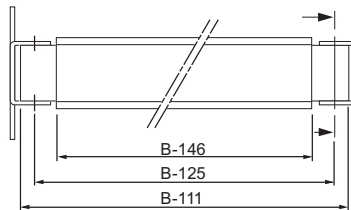

7



Adjustable supports with no rail



Supply: two adjustable supports and fixing elements.

Reference
NSYMF51D

Power distribution

Modular distribution

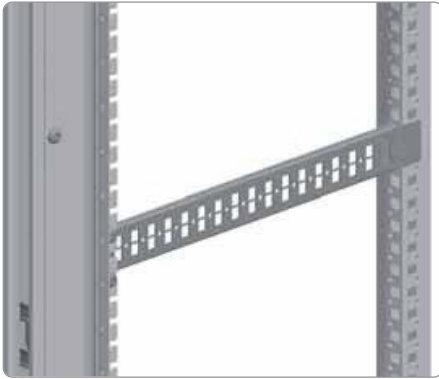

Reinforced plate supports

- Supports for fixing the partial mounting plate for small non-modular equipment or material-supporting cross rails for heavy equipment. See partial mounting plate, page 7/20.
- Direct fixing by screws to the vertical uprights of the modular chassis-coupling set, and at the rear directly to the structure (**Spacial SF**) and on universal or quick-fixing cross rails (see page 7/36) installed vertically in the back of the enclosure (**Spacial SM**).
- Material: zinc-coated steel.



Supply: two supports and fixing elements.

Nominal dimensions (mm)		No. of cut-outs (\varnothing 5.2 mm)	Reference
Depth (C)			
300		3	NSYMPS30
400		7	NSYMPS40
500		11	NSYMPS50
600		15	NSYMPS60
800		23	NSYMPS80

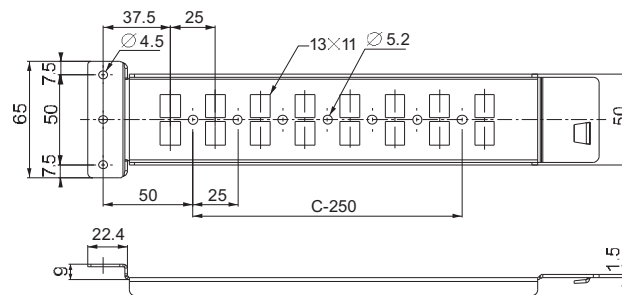

[For ranges
SF, SM]

7

Power distribution

Modular distribution

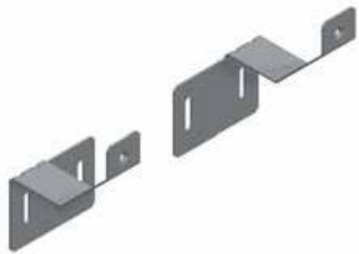

[For ranges
SF, SM]

Cable duct fixing supports

- Supports for fixing cable-distribution gutters in the modular distribution chassis.
- Allows the fixing of gutters in horizontal and vertical position on the same plane to facilitate cable distribution.
- Installation by screws directly on the rail supplied with the fixed or adjustable rail, page 7/81.
- Material: zinc-coated steel.



Supply: six supports (three on the right and three on the left) and fixing elements.

Reference

NSYMCDFIX

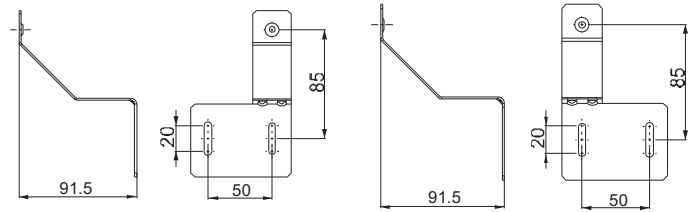

Left support

Right support

Power distribution

Busbars and blocks



Side panels for the side busbar chamber

- Set of 2 side panels fixed to the outside.
- Captive screws.
- Material: steel.
- Finish: painted with epoxy-polyester resin, textured RAL-7035 grey.



Supply: two side panels with external fixing and fixing elements.

Nominal dimensions (mm)		Reference
Height	Depth	
1800	400	NSY2SP184
	500	NSY2SP185
	600	NSY2SP186
2000	400	NSY2SP204
	500	NSY2SP205
	600	NSY2SP206
	800	NSY2SP208
2200	600	NSY2SP226

Power distribution

Busbars and blocks

For ranges
SF, SM, SFX

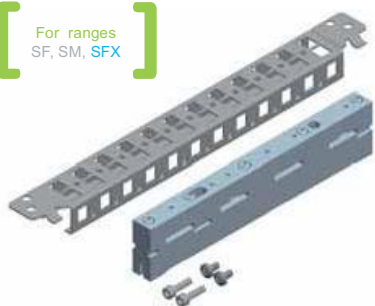

630 A bar support

- **Spacial SF**: support prepared for coupling directly to the structure of the enclosure.
- A universal cross rail needed to replace the 400 mm quick-fixing cross rail.
- **Spacial SM**: installation by means of a vertical adaptation profile and 40-mm universal cross rails (1 row).
- Maximum nominal rating 630 A.
- Determine according to the enclosed table the cross-section of the bars and the distance between supports, according to the nominal and short-circuit current respectively.

Supply: one 630 A bar support, one 40-mm quick-fixing cross rail and fixing elements.

Nominal dimensions (mm)	Reference
Width/Depth	
400	NSYBS400
500	NSYBS500
600	NSYBS600
800	NSYBS800

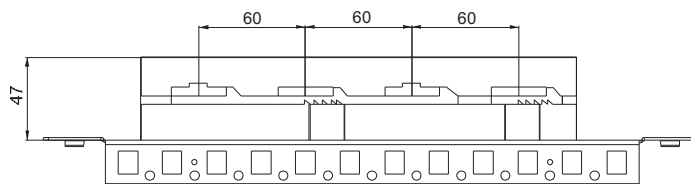

7

Nominal rating IP55 NR (A)	No. of bars per phase	Bar cross-section (mm)	Bar cross-section (mm ²)	Maximum distance between bar supports according to the short-circuit current (mm)							Neutral (mm)	Earth (mm)
				I _{cc} kA								
				12	23	30	39	52	66	69		
200	1	12 × 5	60	525	525	525	400	250	-	-	-	-
250	1	12 × 5	75	575	575	575	450	325	-	-	-	-
320	1	20 × 5	100	600	600	600	475	350	150	-	12 × 5-10	-
390	1	25 × 5	125	600	600	600	475	350	150	-	12 × 5-10	6 × 3
440	1	30 × 5	150	650	650	650	650	525	400	350	20 × 5-10	10 × 3
500	1	20 × 10	200	675	675	675	525	350	150	-	25 × 5-10	10 × 6
600	1	30 × 10	300	675	675	675	600	475	325	275	30 × 5-10	10 × 6

630 A busbar end cover

- Busbar end protection.
- Direct installation on the actual bar support (insulator).

Supply: two 630 A bar support plates and fixing elements.



Reference
NSYBSC630

Power distribution

Busbars and blocks

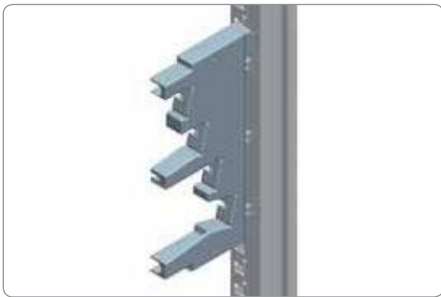
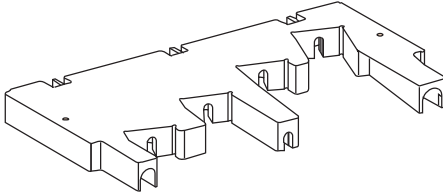

630 A multi-stage bar support

- Support for fixing bars with cross-sections:
 - 15 × 5.
 - 20 × 5.
 - 32 × 5.
 - 32 × 8.
- The orientation of the copper bars makes tightening easier and allows better circulation of the cables.
- It can be 3-pole or 4-pole, with gauges from 160 to 630 A.
- Mounting on mounting plates (see page 7/10) or cross-rails (see page 7/36).
- Electrical characteristics:
 - Rated peak withstand current I_{pk} (kA):
 - 30 kA for 160 A busbar.
 - 40 kA for 250 A busbar.
 - 55 kA for 400 A and 630 A busbar.
 - Rated insulation voltage U_i = 750 V.
- Material: insulating plastic.



Supply: 1 multi-stage bar support and fixing elements.

- M6 × 25 self-tapping screws are required for fixing on the cross-rails, not included.

Reference

04192

- The following table shows:
 - The cross-section of the bars that will be used according to the current-carrying capacity in the busbar.
 - The distance between the bar supports that will be installed according to the rated short-time withstand current: I_{cw}.

Amperage (A)	Bar cross-section (mm)	Centre-to-centre distance of the supports (mm)				
		I _{cw} (kA eff/1 s)				
		10	13	15	20	25
160	15 × 5					
250	20 × 5					
400	32 × 5		450			300 (1)
630	32 × 8				300	

(1) I_{cw} (kA eff/0.6 s).

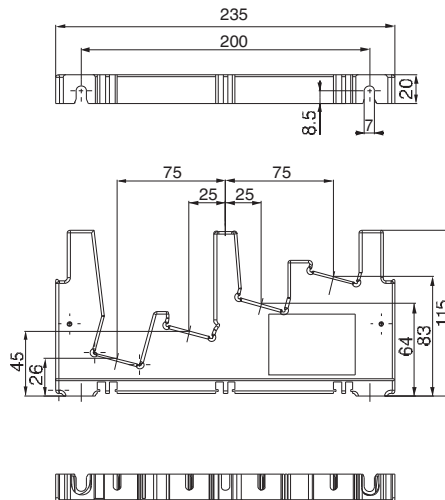

Power distribution

Busbars and blocks

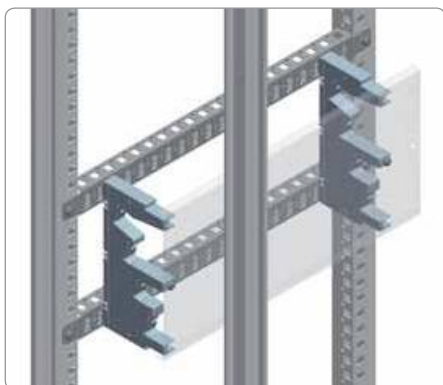

Screen for 630 A multi-stage busbar

- Protects against direct contact from the front in the connections of the busbar.
- Direct mounting on the actual support.
- Length: 1500 mm.



Supply: 1 screen for multi-stage busbar and fixing elements.

Reference

04197



160 A / 630 A four-pole multi-stage distribution block

- The orientation of the copper bars makes tightening easier and allows better circulation of the cables.
- The copper bars are supplied with:
 - 13 holes for M6, for the outlets.
 - 4 holes with $\varnothing 12.2$ for supplying the distribution block.
- It can be 3-pole or 4-pole, with gauges from 160 to 630 A.
- Installation:
 - Mounting plates (see page 7/10) or cross-rails (see page 7/37).
- Electrical characteristics:
 - Rated operating current (40 °C):
 - 160 A.
 - 250 A.
 - 400 A.
 - 630 A.
 - Rated insulation voltage $U_i = 750$ V.
 - Rated short-time withstand current = I_{cw} :
 - 10 kA eff/1 s for 160 A distribution block.
 - 13 kA eff/1 s for 250 A distribution block.
 - 20 kA eff/1 s for 400 A distribution block.
 - 25 kA eff/1 s for 630 A distribution block.
 - Rated peak withstand current = I_{pk} :
 - 30 kÅ for 160 A distribution block.
 - 30 kÅ for 250 A distribution block.
 - 40 kÅ for 400 A distribution block.
 - 40 kÅ for 630 A distribution block.
 - Rated impulse withstand voltage: $U_{imp} = 8$ kV.
- Distribution: 13 outlets for phase with max. 50 mm².



Supply: 2 multi-stage bar supports, 4 cut-out copper bars with a pitch of 25 mm and 1 IPxxB insulating front cover.

- M6 \times 25 self-tapping screws are required for fixing on the cross-rails, not included.

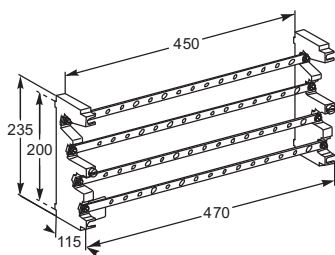
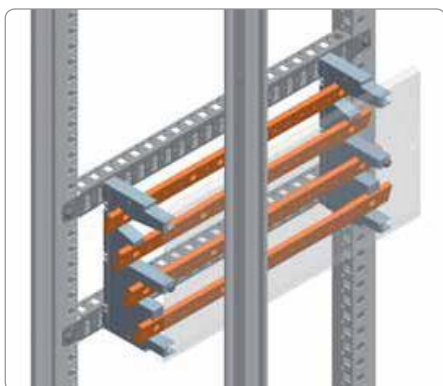

Model	Bar cross-section (mm)	Reference
160 A (40 °C)	15 \times 5	04052
250 A (40 °C)	20 \times 5	04053
400 A (40 °C)	32 \times 5	04054
630 A (40 °C)	32 \times 8	04055

Power distribution

Busbars and blocks



Distribloc distribution block

- 4-pole distribution block.
- The outlets are connected by the front, on spring terminals. The pressure of this spring is adapted automatically to the cross-section of the conductor. It is independent from the operator.
- Degree of protection: IPxxB (protection against direct contacts).
- Installation:
 - Clips onto DIN rails (see page 7/50) and/or mounting plates (see page 7/10).
- Electrical characteristics:
 - Rated operating current (40 °C):
 - 125 A for Distribloc 125.
 - 160 A for Distribloc 160.
 - Resistance to short-circuit currents: the interrupting capacity reinforced by filiation is conserved in the case of automatic switch associations.
 - According to low-voltage switchgear standards UNE-EN 60947-7-1 and/or UNE-EN 60439-1.
 - Rated impulse withstand voltage: $U_{imp} = 8 \text{ kV}$.
- Power supply:
 - 125 A Distribloc: screw terminal for flexible cables from 6 to 35 mm² (rigid from 10 to 35 mm²).
 - 160 A Distribloc: by prefabricated flexible connection, supplied.
- Distribution (for 125 A and 160 A Distribloc):
 - On spring terminals:
 - 2 outlets connected by flexible cables from 1 to 10 mm².
 - 3 outlets connected by flexible cables from 1 to 6 mm².
 - 7 outlets connected by flexible cables from 1 to 4 mm².
 - On screw terminals:
 - 1 outlet connected by flexible cables from 4 to 16 mm² (rigid from 4 to 25 mm²).



Supply: single-piece distribution block, 1 IPxxB modular insulating screen and self-adhesive labels for identifying the phases. Prefabricated flexible connection in Distribloc 160.

Model	Reference
125 A distribution block	04045
160 A distribution block (with 4 flexible connectors)	04046

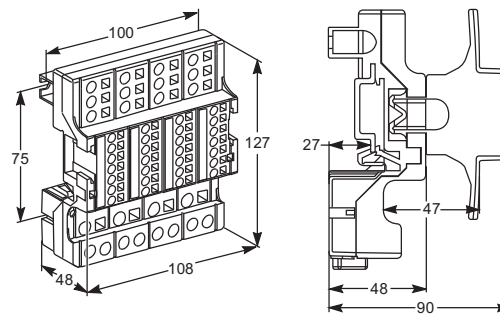

Power distribution

Busbars and blocks

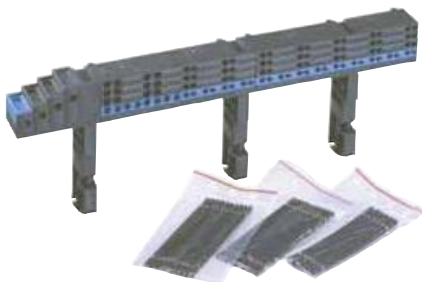

Multiclip distribution block

- Distribution in a full row (48 steps) of modular switchgear. Generally supplied on a busbar.
- The outlets are connected by the front, without screws on the spring terminals. The contact pressure of the cable is independent from the operator.
- It adapts automatically to the cross-section of the conductor (min. cross-section 1 mm²).
- Each spring only accepts one flexible cable at a time.
- Degree of protection: IPxxB (protection against direct contacts).
- Installation: clipped onto the rear of a modular rail, for example Ref. 03004, or screwed on mounting plates (see page 7/10).
- Electrical characteristics:
 - Rated insulation voltage: $U_i = 750 \text{ V}$.
 - Rated impulse withstand voltage: $U_{imp} = 8 \text{ kV}$.
 - Resistance to short-circuit currents: the interrupting capacity reinforced by filiation is conserved in the case of automatic switch associations.
- 200 A Multiclip:
 - 10 mm² cable outlet: $I_{max} = 50 \text{ A}$.
 - 2 different outlets with cables of 10 mm²: $I_{max} = 63 \text{ A}$.
- Distribution:
 - For 2-pole 200 A Multiclip (04012):
 - 12 phase and neutral connection points.
 - For 3-pole and 4-pole 200 A Multiclip (04013 and 04014):
 - 12 connection points for each phase.
 - 18 connection points for the neutral.



Supply: Multiclip distribution block, 10 mm² bared copper connections with a length of 100 mm, 2 bags of 12 connections, terminal covers for the supply poles (IPxxB), screws for the supply poles and fixing elements.

Model	Reference
200 A 2-pole	04012
200 A 3-pole	04013
200 A 4-pole	04014

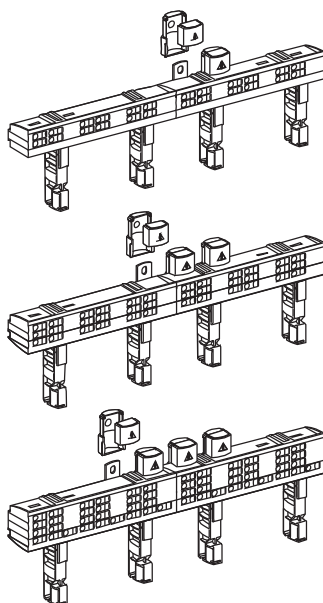

Power distribution

Busbar support accessories

For ranges
SF

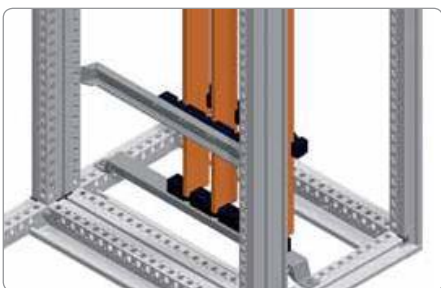

Vertical bar support up to 3200 A

- Support prepared for fixing bars in vertical position, mounted directly on the structure of the enclosure. Adjustable height with a pitch of 25 mm.
- Maximum nominal rating:
 - 1600 A for 5-mm bars.
 - 3200 A for 10-mm bars.
- The number and the distance between supports, according to the nominal current and the short-circuit current, are stated in the enclosed table.

Supply: two insulating bar supports, one metal vertical support and fixing elements.

Nominal dimensions (mm)	Reference
Width/Depth (B)	
400	NSYBVS400
500	NSYBVS500
600	NSYBVS600
800	NSYBVS800

- The number and the distance between supports, according to the nominal current and the short-circuit current, are stated in the enclosed table.

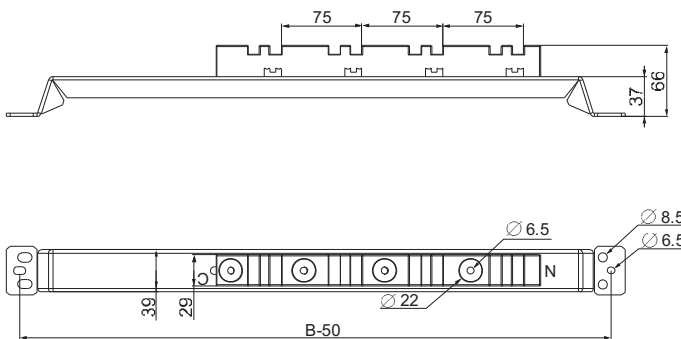

Sets of vertical bars			Maximum distance between bar supports (mm) according to the short-circuit current, I _{cc} (kA)								
Nominal rating I _n (A)	Cross-section (mm)	No. of bars per phase	I _{cc} (kA)								
			15	25	30	40	50	60	65	75	85
750	60 × 5	1	650	325	325	217	-	-	-	-	-
900	80 × 5	1	650	325	325	217	-	-	-	-	-
1250	60 × 5	2	650	325	325	217	163	-	-	-	-
1600	80 × 5	2	650	325	325	217	217	-	-	-	-
1080	50 × 10	1	650	650	650	325	217	217	-	-	-
1250	60 × 10	1	650	650	650	325	325	217	-	-	-
1600	80 × 10	1	650	650	650	325	325	217	-	-	-
1850	50 × 10	2	650	650	325	325	325	217	217	217	-
2000	60 × 10	2	650	650	650	325	325	325	217	217	-
2500	80 × 10	2	650	650	650	325	325	325	325	217	-
2800	100 × 10	2	650	650	650	650	325	325	325	217	163

Note: The current-carrying capacity values in the set of bars are given for an ambient temperature of 35 °C around the busbar. The nominal rating values are indicated for IP55. The maximum values (3200 A) are achieved with ambient temperatures of less than 35 °C, varying according to the configuration and position of the busbar. See enclosed table of current-carrying capacities according to temperature, page 7/95.

Power distribution

Busbar support accessories

Selection of the number of supports

- The number and cross-section of the bars are chosen for each phase, according to the nominal rating.
- Determine the short-circuit current I_{cc} (kA) and use the table to obtain the maximum distance between supports.
- Based on the maximum distance between supports, obtain the number of supports to be installed according to the following criterion:
 - Three vertical supports must necessarily be fixed to the structure (ref. **NSYBVS...**).
 - If more than three supports are required, the support arms must be used (ref. **NSYBSA**), in even numbers (2, 4, etc.).
- Example:
 - In: 2000 A, two 60×10 bars are required per phase.
 - I_{cc} : 50 kA.
 - According to the table of maximum distance between supports they must be 325 mm.
 - Length of the copper bars: 1800 mm.
 - $1700/325 = 5,23$, which means 6 supports, 3 fixed vertical supports and 3 support arms + 1 extra support for the number to be even.

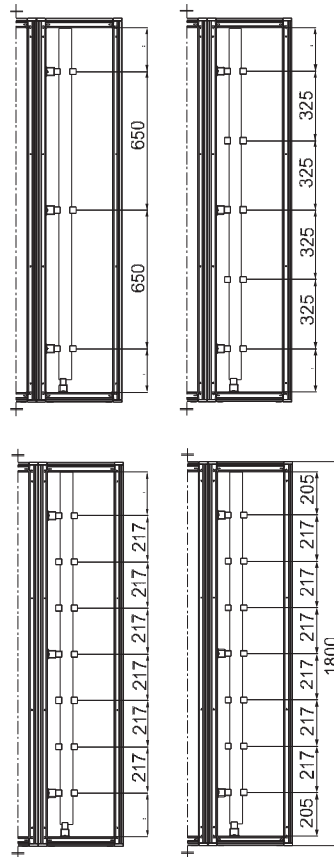

Power distribution

Busbar support accessories



Setting support

- Bottom support for bars in vertical position.
- It is fixed to the bottom frame of the enclosure.
- It is required for supporting the bars.
- It is not considered a bar support when calculating the number of supports.

 Supply: one insulating bar support, one metal vertical support and fixing elements.

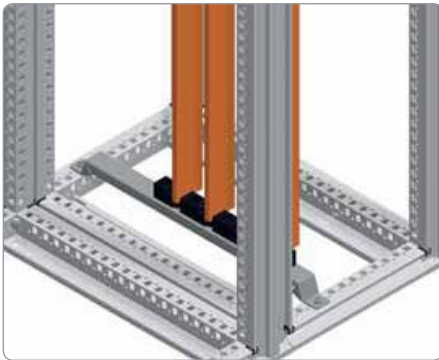

Nominal dimensions (mm)	Reference
Width/Depth	
400	NSYAS400
500	NSYAS500
600	NSYAS600
800	NSYAS800

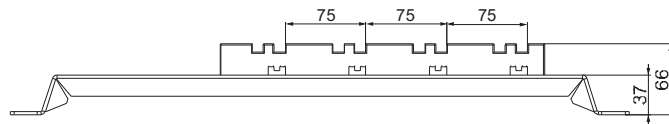

[For ranges SF]

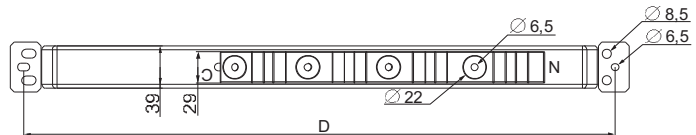

Power distribution

Busbar support accessories



[For ranges SF, SFX]

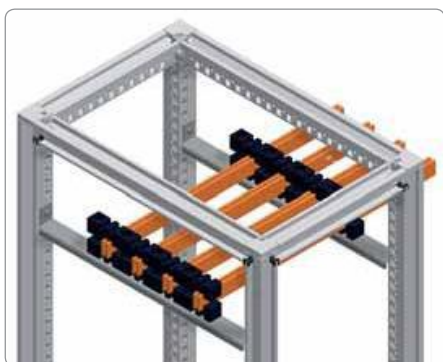

Horizontal bar support up to 3200 A

- Support prepared for fixing bars in horizontal position.
- Direct mounting to the structure of the enclosure, on the vertical uprights, at any height, adjustable with a pitch of 25 mm.
- Maximum nominal rating:
 - 1600 A for 5-mm bars.
 - 3200 A for 10-mm bars.
- The number and the distance between supports, according to the nominal and short-circuit current, are stated in the enclosed table.

Supply: two insulating bar supports, one metal horizontal support and fixing elements.

Nominal dimensions (mm)	Reference
Width/Depth (B)	
500	NSYBHS500
600	NSYBHS600
800	NSYBHS800

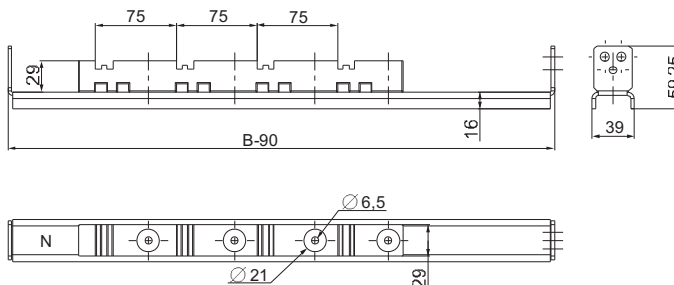

7

Sets of vertical bars			Maximum distance between bar supports (mm) according to the short-circuit current I _{cc} (kA)									
Nominal rating I _n (A)	Cross-section (mm)	No. of bars per phase	15	25	30	40	50	60	65	75	85	
750	60 × 5	1	650	325	325	217	-	-	-	-	-	
900	80 × 5	1	650	325	325	217	-	-	-	-	-	
1250	60 × 5	2	650	325	325	217	163	163	130	108	81	
1600	80 × 5	2	650	325	325	217	217	163	130	108	81	
1080	50 × 10	1	650	650	650	325	217	217	163	-	-	
1250	60 × 10	1	650	650	650	325	325	217	163	130	108	
1600	80 × 10	1	650	650	650	325	325	217	163	130	108	
1850	50 × 10	2	650	650	325	325	325	217	217	217	163	
2000	60 × 10	2	650	650	650	325	325	325	217	217	163	
2500	80 × 10	2	650	650	650	325	325	325	325	217	163	
2800	100 × 10	2	650	650	650	650	325	325	325	217	163	

Note: The current-carrying capacity values in the set of bars are given for an ambient temperature of 35 °C around the busbar. The nominal rating values are indicated for IP55. The maximum values (3200 A) are achieved with ambient temperatures of less than 35 °C, varying according to the configuration and position of the busbar. See enclosed table of current-carrying capacities according to temperature, page 7/95.

Power distribution

Busbar support accessories

[For ranges SF, SFX]

Selection of the number of supports

- The number and cross-section of the bars are chosen for each phase, according to the nominal rating.
- Determine the short-circuit current I_{cc} (kA) and use the table to obtain the maximum distance between supports.
- Based on the maximum distance between supports, obtain the number of supports to be installed according to the following criterion:
 - Two supports must necessarily be fixed to the structure per enclosure. In the event of enclosure suites, only one support is required, fixed to one of the uprights of the coupling.
 - If more than two supports are required per enclosure, the support arms must be used (ref. **NSYBSA**).

Table of current-carrying capacities according to temperature

Type of bars		Current-carrying capacity (A) according to the ambient temperature around the frame				
Cross-section (mm)	No. of bars per phase	25 °C	30 °C	35 °C	40 °C	45 °C
60 × 5	1	840	790	750	700	650
80 × 5	1	1050	990	900	870	810
60 × 5	2	1420	1350	1250	1180	1090
80 × 5	2	1820	1720	1600	1510	1390
50 × 10	1	1220	1160	1080	1010	940
60 × 10	1	1400	1320	1250	1160	1070
80 × 10	1	1800	1700	1600	1500	1390
50 × 10	2	2090	1980	1850	1740	1610
60 × 10	2	2270	2140	2000	1870	1720
80 × 10	2	2820	2660	2500	2330	2160
100 × 10	2	3200	3100	2800	2720	2510

Note: The rating values according to temperature are not exhaustive, since they depend on the configuration and position of the bars inside the enclosure.



Bar support arm

- Support without fixing to the enclosure, required to guarantee the distance between the bars.
- It is used on bars in both vertical and horizontal position.
- To choose the number of supports, see the tables of maximum distances between supports, pages 7/86, 7/91 and 7/94.



Supply: two insulating bar supports and fixing elements.

Reference
NSYBSA

7

Power distribution

Distribution blocks



Sigma safety terminals

Safety terminals made from self-extinguishing Polyamide-6, with matt black base, **MS-58** brass terminal (DIN 17660), tempered, zinc-plated and dichromated steel ring, and cover made from orange-coloured self-extinguishing polypropylene.

- **Anti-shearing:** the connection is made by means of a tightening mechanism, which distributes the pressure across the entire contact surface, avoiding friction and occasional stress that can damage the conductors.
- **Unloosenable:** the ring that surrounds the brass body guarantees that the pressure exerted by the actual conductors cannot open the terminal and loosen the connection.
- **Full insulation:** all the SIGMA "S" terminals are supplied with a terminal-covering cap, avoiding any accidental contact with live parts.

All the gauges can be coupled together, forming strips of any length. Operating voltage: 500 V.

Section (mm ²)	A	B	C	D	E	Supply	Reference
1 × 4	30	20	13	21	4	20	NSYS04
1 × 6	33	25	16	24	7	20	NSYS06
1 × 10	38	28	16	28	6	20	NSYS10
1 × 16	42	32	19	32	9	20	NSYS16
1 × 35	46	38	23	34	11	20	NSYS2535
1 × 50	52	45	27	40	15	20	NSYSDT5
1 × 70	55	50	30	40	15	20	NSYS70
1 × 100	58	54	33	40	20	10	NSYS95100

Note: Each terminal accepts up to 2 conductors with the specified section.

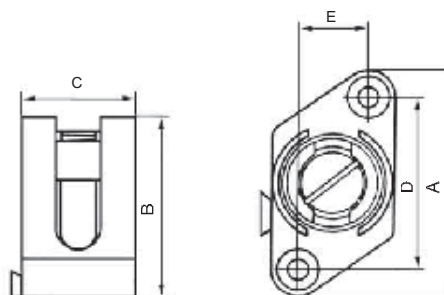

Power distribution Distribution blocks



Bimetal terminals

Terminals specially designed for the junction of cables on plates, their main application is in busbar connections. The bimetal terminals are made from a copper alloy, hot-stamped and tin plated, suitable for connecting a copper or aluminium conductor indistinctly (bimetal).



Supply: 4 bimetal terminals.

Main section (mm ²)	Junction section (mm ²)	Reference
6-50	-	NSYBBH29
6-50	-	NSYBBH29C
10-95	-	NSYBBH30
16-150	-	NSYBBH31
50-240	-	NSYBBH32
6-50	6-50	NSYBBH29D
6-50	6-50	NSYBBH29DC
10-95	10-95	NSYBBH30D
25-150	16-150	NSYBBH31D
95-240	5-240	NSYBBH32D
6-50	-	NSYBBH29P
6-50	-	NSYBBH29PC
6-50	6-50	NSYBBH29DP
6-50	6-50	NSYBBH29DPC

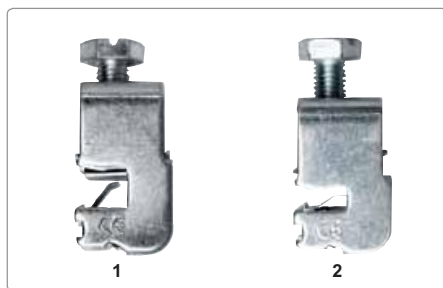

Plate/cable terminals

Entry by plate and junction by cable, plate or terminal.



Supply: 1 junction terminal.

Junction cable-section (mm ²)	Plate thickness (mm)	Fig.	Reference
1.5 to 16	5	2	NSYBPCH516
1.5 to 50	5	2	NSYBPCH550
16 to 120	5	2	NSYBPCH5120
1.5 to 16	10	1	NSYBPCH1016
1.5 to 50	10	1	NSYBPCH1050
16 to 120	10	1	NSYBPCH10120

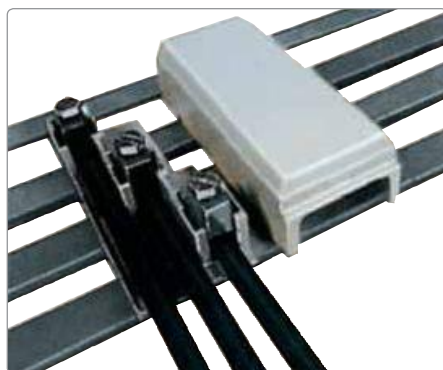

Three-pole junction terminals

Entry by plate and junction by cable (for busbars).



Supply: 1 junction terminal.

Entry plate width (mm)	Entry plate thickness (mm)	Junction cable section (mm ²)	Reference
12/15/20/25/30	5 to 10	35 to 120	NSYBTE630TBT

Power distribution Distribution blocks

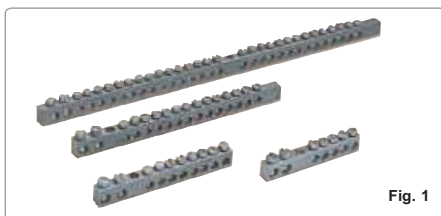

Fig. 1

Earthing strips

For the junction of neutral and earth cables.

- Models **NSYRBL** (Fig. 1) for installation in boxes with insulating rear or by means of insulators, not supplied.
- Models **NSYRBLZ** (Fig. 2) with insulating plinth for fitting under pressure on 12×2 -mm rail.



Supply: 10 earthing strips

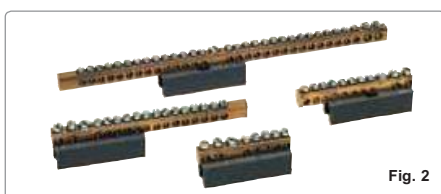

Fig. 2

Number of terminals \times section mm ²	Fig.	Reference
$2 \times 16 \text{ mm}^2 + 5 \times 6 \text{ mm}^2$	2	NSYRBL21656M
$2 \times 16 \text{ mm}^2 + 8 \times 6 \text{ mm}^2$	2	NSYRBL21686M
$2 \times 16 \text{ mm}^2 + 14 \times 6 \text{ mm}^2$	2	NSYRBL216146M
$2 \times 16 \text{ mm}^2 + 29 \times 6 \text{ mm}^2$	2	NSYRBL216296M
$2 \times 16 \text{ mm}^2 + 5 \times 6 \text{ mm}^2$	1	NSYRBLZ21656
$2 \times 16 \text{ mm}^2 + 8 \times 6 \text{ mm}^2$	1	NSYRBLZ21686
$2 \times 16 \text{ mm}^2 + 14 \times 6 \text{ mm}^2$	1	NSYRBLZ216146
$2 \times 16 \text{ mm}^2 + 29 \times 6 \text{ mm}^2$	1	NSYRBLZ216296



Fig. 2

7

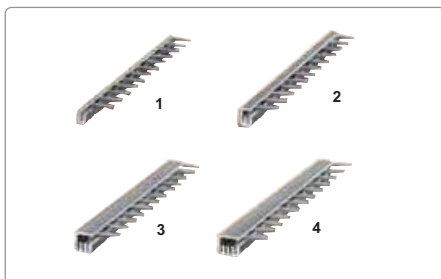

Distribution boards

For distribution in a single row of circuit breakers with a total of 12 modules.



Supply: 10 distribution boards.

N.° of bars	N.° of poles per bar	Fig. n.°	Reference
1	12	1	NSYBDS112
2	6	2	NSYBDS26
3	4	3	NSYBDS34
4	3	4	NSYBDS43

Accessories



Cable management

	7/101
Cable entries	7/102
FL21-type membranes	7/105
IP 65 connector free cable entries system	7/106
Cable entries system with connectors	7/109
PVC cable entries	7/110
Neoprene adjustable cone-shaped entries	7/111
Plugs/Protection rings	7/112
Cable guides	7/113
L-rail for fixing cables	7/114
Plastic cable support	7/115
Door cable-guide	7/115
Adjustable cable ties	7/116
Captive clips	7/116
Cable-tie fixing support	7/117
Self-adhesive support bases	7/117
Corrugated cable-gland tube and fixing support	7/118
Cable-gland for body/door	7/119
Cable-duct and cover	7/120
Cable-duct support	7/121
Plastic foot for cable-duct support	7/122
Label frame	7/122
Insulated-head screw	7/122
Lyre-shaped clamps	7/123
Steel wired cable tray	7/123

Cable management



Minimum size and a high assembly:

Choice

Multiple solutions that can be combined on a single cable-entry plate (machining possible at the plant) or directly on the enclosure. See our customised offer.

- IP 67 ISO cable-glands: for quick installation without tools.
- IP 67 cable-glands.
- IP 65 membranes for quick cable entries with FL21-type cut-out.
- IP 65 plate for quick cable entries with the following types of cut-outs: Harting or circular M50 and M63.
- IP 65 plate for cable entries equipped with Harting-type cut-outs and connectors.

Saves time:
IP 65 membranes for quick cable entries with FL21-type cut-out.

Service:
Direct machining of the cut-out on the body of the enclosure.

Development of the installation:
IP 65 plate for quick cable entries with the following types of cut-outs: Harting or circular M50 and M63.

Smart:
IP 54 plate for cable entries equipped with Harting-type cut-out connectors.

Practical:
IP 67 cable-glands.

Simple:
IP 67 ISO cable-glands: for quick installation without tools.

7

Example of installation on cable-entry plate.



Machining of your plate before painting, with our specific service.

Specific



Cable management

Cable entries

	Description	Diameter	Details	See also the accessories
	Stepped mixed end pieces for IP 55 direct cable entries.	For cables Diameter 23 Diameter 29 Diameter 36 Diameter 44	Page 7/103	Door cable-guide cross-rail Page 7/115
	IP 67 quick cable entries	M12 M16 M20 M25 M32 M40 M50	Page 7/103	Adjustable cable tie Page 7/116
	ISO cable-gland	M12 M16 M20 M25 M32 M40	Page 7/104	Self-adhesive support bases Page 7/117
	IP 65 membranes	For cables with diameters from 8 to 60 mm	Page 7/105	Fixing lugs for the earthing strip Page 7/29
	IP 65 circular cable entries Entries from 3 mm to 14 mm	2 sizes: M50 and M63	Page 7/106	Plastic cable tie fixing support Page 7/116
	IP 65 cable entries without connectors. Entries from 3 mm to 6.5 mm	Dimensions 112 × 36	Page 7/106	Covered cable ducts Page 7/120
	Plates for cable entries with IP 54 connectors	91 × 36 112 × 36	Page 7/109	Duct support Page 7/121

7

Cable management

Cable entries

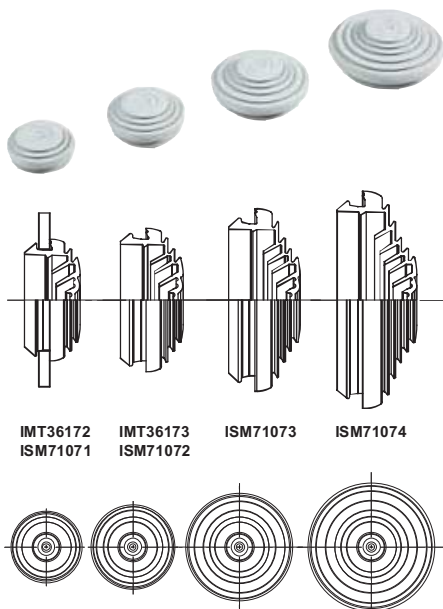

Mixed membrane entries for IP 55 direct cable entries

Common accessories for the Thalassa and Spacial offers

- Membrane entries with multiple membranes.
- IP 55.
- RAL 7035.
- Patented concentric cutting. A simple screwdriver is enough. Enables ultra-quick connection with the choice of several cable diameters for the same membrane entry.
- Material: SBS.
- Minor packaging of 10 pieces.
- Warning: The IP becomes 55.
- Suitable for walls from 2 to 3.2 mm.

Ø (mm)		Minor pack.	References and colours	
Drill hole	Cable / conduit		RAL 9010 white	RAL 7035 light grey
23	4 - 20	10	IMT36172	ISM71071
29	4 - 25	10	IMT36173	ISM71072
36	4 - 32	10	-	ISM71073
44	4 - 40	10	-	ISM71074

Installation of IP 55 entries

- Insertion of rigid cables:
 - Strip at least 100 mm.
 - Push the wires through the membrane.
- Insertion of flexible cables:
 - Pierce partially and soften the membrane with a 4 to 5.5-mm screwdriver.
 - Pass the cable through the membrane.
- Insertion of conduits:
 - Peel the necessary step: 16, 20, 25, 32 or 40 mm.
 - Push the conduit.



IP 67 quick cable entries

- IP 67.
- Material: EPDM plastic.
- Suitable for walls from 1 to 4 mm (0.5 to 2 mm for ref. IMT36179).
- Quick installation with no tools.
- Installation direction: the conical part is inside the box.

ISO	Ø of drill hole	Cable Ø (mm)	Minor pack.	Reference
M12	12.5	3 - 5	50	IMT36179
M16	16	5 - 7	50	IMT36180
M20	20.3	7 - 10	50	IMT36181
M25	25.3	10 - 14	50	IMT36182
M32	32.4	14 - 20	50	IMT36183
M40	40.7	20 - 26	25	IMT36184
M50	50.7	26 - 35	25	IMT36185

Application

- Push the cable entry into the hole. The conical part must be inserted into the box.
- Prepare and loosen the cable entry with a screwdriver. Pass the cable through the cable entry.
- Pull the cable back slightly to fix it in place. The installation is complete.

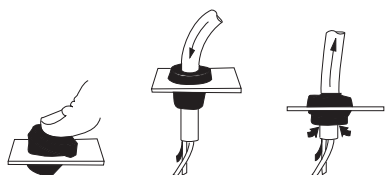

Cable-gland, disc and plug selection table

Ø	1-cable cable gland			Multi-cable disc		Gasket	Blanking plug	Transport plug
	Ref.	Ø min / max (mm)	drill \ (2)	Ref.	Number / Ø (mm)			
M12	ISM71501	3 / 6.5	12.2 (0 + 0.2)	-	-	IMT36151	IMT36161	-
M16	ISM71502	4 / 8	16.2 (0 + 0.2)	IMT36157	2 × Ø 4	IMT36152	IMT36162	IMT36167
M20	ISM71503	6 / 12	20.2 (0 + 0.2)	IMT36158	3 × Ø 4	IMT36153	IMT36163	IMT36168
M20 (1)	IMT36150	6 / 12	20.2 (0 + 0.2)	IMT36158	3 × Ø 4	IMT36153	IMT36163	IMT36168
M25	ISM71504	11 / 17	25.2 (0 + 0.2)	IMT36159	4 × Ø 5	IMT36154	IMT36164	IMT36169
M32	ISM71505	15 / 21	32.2 (0 + 0.3)	IMT36160	6 × Ø 5	IMT36155	IMT36165	IMT36170
M40	ISM71506	19 / 28	40.5 (0 + 0.3)	-	-	IMT36156	IMT36166	IMT36171

(1) Cable-gland with high resistance to fire.
 (2) In brackets: tolerance.



ISO cable-gland

Ø	Reference	TD	TL	Wrench	Thread
M12	ISM71501	12	6	15	1.5
M16	ISM71502	16	8	19	1.5
M20	ISM71503 - IMT36150	20	10	24	1.5
M25	ISM71504	25	8	29	1.5
M32	ISM71505	32	10	36	1.5
M40	ISM71506	40	10	46	1.5

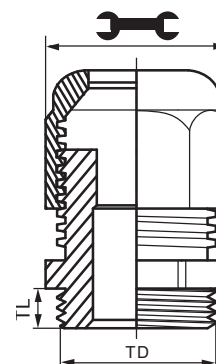

- IP 68, 5 bars.
- According to standard IEC 62208.
- RAL 7035 grey.
- Material: PA6, neoprene gasket.
- Usage temperature: - 30 ... + 80 °C up to + 150 °C intermittently.
- The cable-glands are supplied with nuts.
- The IP is guaranteed with no gasket between the cable-gland and the thermoplastic box. A gasket available as an accessory guarantees the seal in the event of installation on a steel enclosure.
- The cable-gland (ref. **IMT36150**) is especially recommended for security circuits (glow wire resistance: 960 °C).
- Pack of 20 (M12 to M20), 10 (M25 and M32), 5 (M40).

7



Multi-cable disc



Blanking plug



Transport plug

Cable-gland gasket

- Batch of 100 (M12 to M25), 50 (M32), 25 (M40).

Multi-cable disc

- It is possible to pass several cables through a single cable-gland using the multi-cable bushing.

Blanking plug

- It is screwed into the cable-gland's place.
- Pack of 20 plugs (M12 to M15), 10 plugs (M32), 5 plugs (M40).

Transport plug

- It is installed to block the cable-gland during transport or during maintenance operations.
- Pack of 20 plugs (M16 to M25), pack of 10 (M32), pack of 5 (M40).

Cable management

Cable entries

FL21-type membranes for IP 65 cable-entry plate

Number of cable entries	Diameter of the cable entry (∅ mm)											Reference
	5-7	6-10	8-12	8-16	10-14	12-18	14-20	17-32	20-26	24-54	30-60	
0												NSYAECPLBP
7				4						2	1	NSYAECPLT7
25	4		4		12		4		1			NSYAECPLT25
35		2	14		16	2		1				NSYAECPLT35

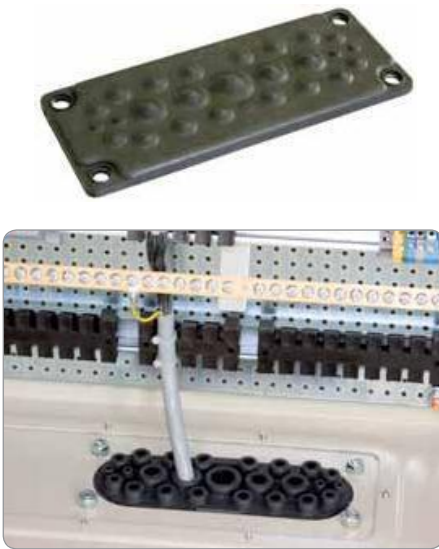

Sealed cable entries made from insulating material (fire resistance: V0 according to UL 94).

- Guarantees a degree of protection of IP 65.
- Dark grey colour.
- Installation on pre-cut plates or direct installation on the enclosures with our specific offer. Please consult us.
- 3 models: 7 to 35 cable entries.
- Cover for cut-out ref. **NSYAECPLBP**.

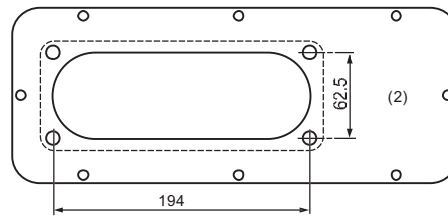

Features of the membranes

NSYAECPLT7

Symbol	For cable ∅	No. of entries
●	8-16	4
○	24-54	2
⊕	30-60	1

NSYAECPLT25

Symbol	For cable ∅	No. of entries
●	5-7	4
●	8-12	4
○	10-14	12
⊖	14-20	4
⊕	20-26	1

NSYAECPLT35

Symbol	For cable ∅	No. of entries
●	6-10	2
●	8-12	14
○	10-14	16
⊖	12-18	2
⊕	17-32	1

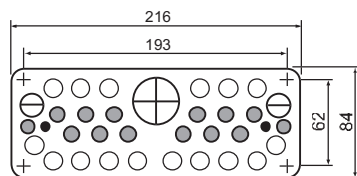
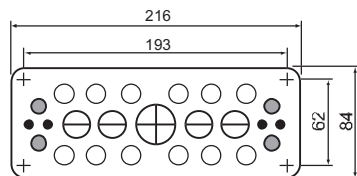
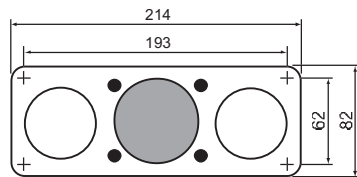

Cable management

Cable entries



IP 65 connector-free cable entries: Two solutions to suit your application

Circular

Compact, flexible system for inserting cables in electrical enclosures or connection boxes, for example:

Specifications

- IP 65 tightness.
- Fire resistance: V0.
- Cut-outs $\varnothing 50$ and 63 mm.
- Installation by nut, up to Spacial wall-mounting steel enclosure size $700 \times 500 \times 250$ mm.
- 2 installation methods are possible for sizes larger than $700 \times 500 \times 250$ mm: clipping or screwing (installation by screwing recommended).

 Composition: 10 units.

 Reference by unit. Order by multiples of 10 (10, 20, 30...).

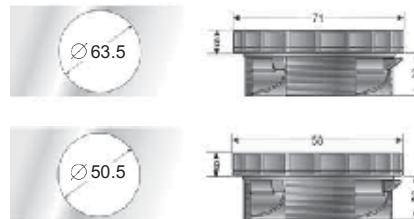

Rectangular

Compact, flexible system for inserting cables in electrical enclosures or connection boxes, for example:

- External dimensions: $146 \times 14 \times 58$ mm.
- Drill-hole diameter: 112×36 mm.

Specifications

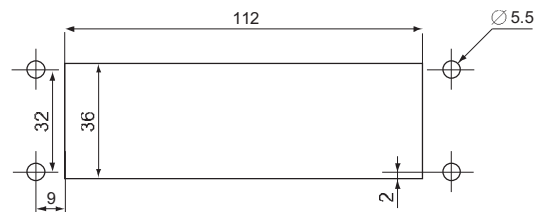

- IP 65 tightness.
- Fire resistance: V0.
- Identical cut-outs to the 24-point connectors.
- Installation by screwing, up to Spacial wall-mounting steel enclosure size $700 \times 500 \times 250$ mm.
- 2 installation methods are possible for sizes larger than $700 \times 500 \times 250$ mm: clipping or screwing (installation by screwing recommended).







Cable management

Cable entries

Selection guide

Type	No. of openings	Dimensions/ cut-out \varnothing	Diameter of the cable entry (\varnothing mm)								Reference
			3-5.5	4.3-8.1	3-6.5	3.6-6.5	5-9.2	6-10	8-12.5	9.6-15.9	
	4	50.5						3		1	NSYTSAM504SE
	8	50.5				7		1			NSYTSAM508SE
	8	63.5			2		4			2	NSYTSAM638SE
	13	63.5	6			6		1			NSYTSAM6313SE
	14	112x36			6		4				NSY TSA2414SE
	17	112x36					17			4	NSY TSA2417SE
	22	112x36			16		4		2		NSY TSA2422SE
	23	112x36		23							NSY TSA2423SE
	29	112x36			29						NSY TSA2429SE

Position of the holes on the circular cable entries with diameters 50 and 63 mm

Type	Hole diameter	Reference
	1 x \varnothing 9.6 to 15.9 mm 3 x \varnothing 6 to 10 mm	NSYTSAM504SE
	7 x \varnothing 6 to 10 mm 1 x \varnothing 6 to 10 mm	NSYTSAM508SE
	2 x \varnothing 3 to 6.5 mm 4 x \varnothing 5 to 9.2 mm 2 x \varnothing 9.6 to 15.9 mm	NSYTSAM638SE
	6 x \varnothing 3 to 5.5 mm 6 x \varnothing 3.6 to 6.5 mm 1 x \varnothing 6.0 to 10.0 mm	NSYTSAM6313SE

Cable management

Cable entries

Diagrams of dimensions and positions of the holes on a rectangular cable entry

Cable entries (mm)	Type	Reference
6×3 to 6.5 4×5 to 9.2 4×9.6 to 15.9		NSYTSA2414SE
17×9.2		NSYTSA2417SE
29×3 to 6.5		NSYTSA2429SE
16×3 to 6.5 4×5 to 9.2 2×8 to 12.5		NSYTSA2422SE
23×4.3 to 8.1		NSYTSA2423SE

7



See also the accessories



Adjustable cable tie page 7/110

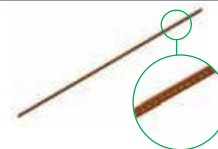

Cable management page 7/140

Cable management

Cable entries

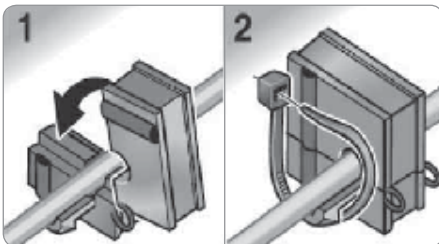

Cable entries system with connectors

- System in two parts for inserting cables and hoses in the enclosures.
- Several ribbed gaskets adapted to the diameter of the cable.
- Models:
 - 24/0: plain.
 - 24/4: for two small gaskets with cable diameters between 3 and 14 mm, and two large gaskets with cable diameters between 16 and 31 mm.
 - 24/10: for 10 small gaskets with cable diameters between 3 and 14 mm.
- Water/dustproof: IP54 for plate with entries, IP65 for plain plate.
- Identical recessing as for 24-point connectors.
- Material: PA.

Supply: 1 plate and fixing elements.

Cable-gland plates for connectors		
Types	No. of entries	Reference
Plate 24/0	0	NSYDCE240
Plate 24/4	4	NSYDCE244
Plate 24/10	10	NSYDCE2410

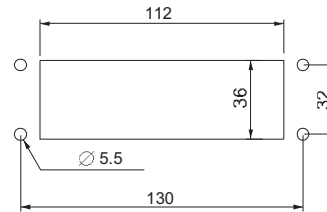

Gaskets for cable entries system

- Ribbed gaskets adapted to the diameter of the cable.
- They are installed on the cable-gland plates for connectors.
- Models:
 - Small gaskets with diameters between 3 and 14 mm.
 - Large gaskets with diameters between 16 and 31 mm.
- Material: thermoplastic rubber.

Supply: 10 units.

Reference by unit. Order by multiples of 10 (10, 20, 30...).

	∅ cable (mm)	Reference
Small gasket	Plain	NSYCEJD
	3-4	NSYCEJD3
	5-6	NSYCEJD5
	7-8	NSYCEJD7
	9-10	NSYCEJD9
	11-12	NSYCEJD11
	13-14	NSYCEJD13
Large gasket	16-17	NSYCEJD16
	18-19	NSYCEJD18
	20-21	NSYCEJD20
	22-23	NSYCEJD22
	24-25	NSYCEJD24
	26-27	NSYCEJD26
	28-29	NSYCEJD28
	30-31	NSYCEJD30

Cable management

Cable entries



PVC adjustable cone-shaped entries

PVC insulating cone-shaped entries which can be cut according to the volume of cables. Installation on insulating distribution boxes and protection boxes; generally suitable for thicknesses matching the dimension E.

Fig.	Ø A	Ø B*	Ø C	Ø D	E	F	Capacity		Composition	Reference
							Cable Ø	Tube		
1	25	21.5	18	5	3.2	13	5 to 18	Pg. 9 to 11	50	NSYECPC3
1	33	29.5	26	5	3.2	20	5 to 26	Pg. 9 to 16	25	NSYECPC5
1	43	38.5	36	5	3.2	22	5 to 36	Pg. 9 to 21	25	NSYECPC6
2	70	63	60	28	3	20	28 to 60	Pg. 21 to 48	10	NSYECPC9
2	98	90	87	28	3	23	28 to 87	Pg. 21 to 48	10	NSYECPC15

*Drill-hole for mounting.

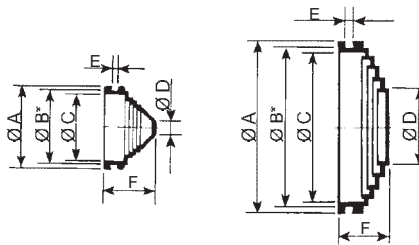

PVC adjustable cone-shaped entries

PVC insulating cone-shaped entries, threaded for the entry of Pg tubes and detachable rear for cable entry. They allow the entry of all types of normal and flexible cables and tubes, with diameters comprised between the dimension B and the thread root (maximum Ø).

7

Ø A	Ø B*	Ø C	Ø D	E	F	Capacity		Composition	Reference
						Cable Ø	Tube		
25	19.5	16	3	1.2	21	3 to 16	Pg. 9	50	NSYEC1
25	19.5	16	6	1.2	21	6 to 16	Pg. 11	50	NSYEC2
27	21.5	18	7	1.2	23	7 to 18	Pg. 13.5	50	NSYEC3
29.5	23.5	20	8	1.2	26	8 to 20	Pg. 16	25	NSYEC4
35	29.5	26	10	1.2	27	10 to 26	Pg. 21	25	NSYEC5
42	38.5	35	12	1.5	30	12 to 35	Pg. 29	25	NSYEC6
52	48.5	44	13	1.5	30	13 to 44	Pg. 36	25	NSYEC7

*Drill-hole for mounting.

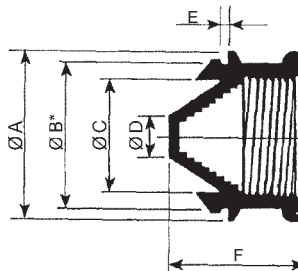

Cable management

Cable entries



Neoprene adjustable cone-shaped entries

Neoprene adjustable cone-shaped entries. This material has excellent mechanical, dielectric and thermal properties and can resist corrosive environments.



Composition: 25 units.



Reference by unit. Order by multiples of 25 (25, 50, 75...).

Ø A	Ø B*	Ø C	Ø D	E	F	Capacity		Composition	Reference
						Cable Ø	Tube		
24	19.5	14	8.6	1.75	20	8.6 to 14	-	50	NSYECN1
34	29.5	26	9	1.75	22	9 to 26	Pg. 9 to 16	25	NSYECN5
43	38.5	32	9	1.75	28	9 to 32	Pg. 9 to 21	25	NSYECN6
53	48.5	36	9	1.75	32	9 to 36	Pg. 9 to 29	25	NSYECN7
71	65	60	9.2	1.75	40	9.2 to 60	Pg. 9 to 48	10	NSYECN10

*Drill-hole for mounting.

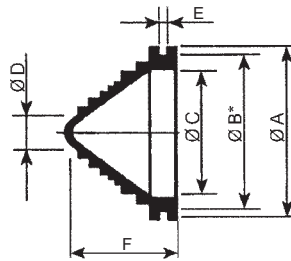

Cable management

Cable entries



Plugs

Made from black PVC, they are suitable for all diameters of knock-out holes on the boxes.

Ø A	Ø B	Ø C	D	E	Composition	Reference
25.5	20	16.5	7	1.2	50	NSYTC1
27.5	22	19	7	1.2	50	NSYTC2
29.5	24	21	7	1.2	50	NSYTC3
36.5	29.5	27	7	1.5	25	NSYTC4
46.5	39	35	7.5	1.5	25	NSYTC5
56.5	49	45	7.5	1.5	25	NSYTC6

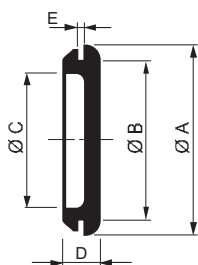

Protection rings

Protection rings for cables at the exit of the tubes. They are made from flexible, strong, light-grey PVC.



Composition: 100 units.



Reference by unit. Order by multiples of 100 (100, 200, 300...).

A	Ø B	Tube	Reference
15.2	12.7	Pg. 9	NSYPC1
18.6	16	Pg. 11	NSYPC2
20.4	17.8	Pg. 13.5	NSYPC3
22.5	19.8	Pg. 16	NSYPC4
28.3	25.3	Pg. 21	NSYPC5
37	33.6	Pg. 29	NSYPC6
47	43	Pg. 36	NSYPC7

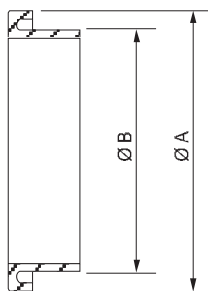

Cable management

Cable holding



For ranges
SF, SM, SFX, SMX

Lower cable-guide cross-rail

- It allows quick fixing of cables entering and exiting the enclosure.
- Depth adjustable every 25 mm.
- Spacial SF: for suitable enclosures with widths of 1200 and 1600 mm, use the adaptation kit for 2-door suitable enclosures, see page 7/19.
- Spacial SM: for floor-standing enclosures with a width of 1200 mm, a top/bottom mounting rail installed in central position is required. See page 7/21.
- Spacial SFX: no adaptation piece is required for the 1200-mm suitable enclosures.
- Spacial SMX: no adaptation piece is required for the 1600-mm floor-standing enclosures.
- Material: galvanised steel.

Composition: 1 cable-guide cross-rail and fixing elements.

Spacial dimensions (mm)	Reference
Width (B)	
600	NSYCFP60
800	NSYCFP80
1000	NSYCFP100
1200	2 × NSYCFP60
1600	2 × NSYCFP80

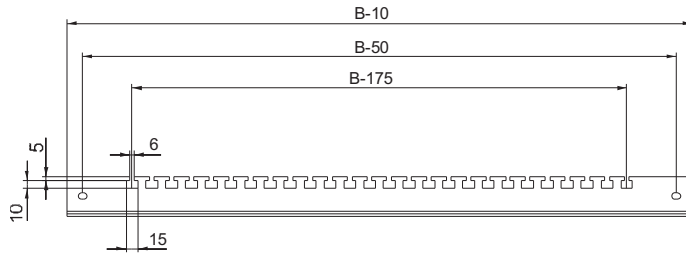

For ranges
SF, SM, SFX, SMX

Cable-guide cross-rails for framework

- Spacial SF and SFX: support for direct mounting on the framework, cross-rails or rails.
- Spacial SM: fixing on the bottom mounting rail, or on the floor-standing enclosure by means of adaptation rails and 40-mm universal cross-rails (1 row) in vertical position.
- Spacial SMX: fixing on the bottom mounting rail and 40-mm universal cross-rails (1 row) in vertical position.
- Support types:
 - Angle support at 90°: for vertical cable fixing.
 - Angle support at 120°: for fixing cables near the cable entry.
- Material: zinc-coated steel.

Composition: 2 supports and fixing elements.

Nominal dimensions (mm)	Support angle	Reference
Width / Depth (B / C)		
600	90°	NSYCFS96
	120°	NSYCFS126
800	90°	NSYCFS98
	120°	NSYCFS128

7

Cable management

Cable holding

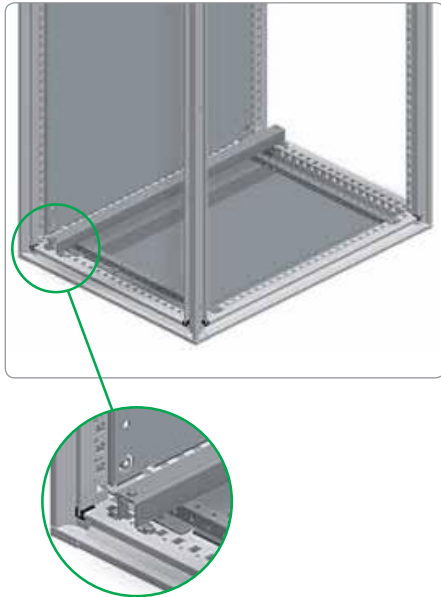

L-rail for fixing cables

- Rail for fixing cables entering from the bottom.
- **Spacial SF and SFX:** fixing to the bottom frame, above the cable entry, or else to the plinth, using the plinth cross rails, see page 3/47.
- **Spacial SM and SMX:** fixing to the bottom adjustment rails, above the cable entry, or else to the plinth, using the plinth cross rails, see page 3/47.
- Adjustable depth with a pitch of 25 mm.
- The cables are fixed to the rail by means of metal clamps.
- Material: zinc-coated steel.
- It is not possible to mount it on a plinth cross rail.



Supply: one rail, two mounting supports and fixing elements.

Nominal dimensions (mm)	Reference
Width	
600	NSYFCG60
800	NSYFCG80
1000	NSYFCG100
1200	NSYFCG120
1600	NSYFCG160

[For ranges SF, SM, SFX, SMX]

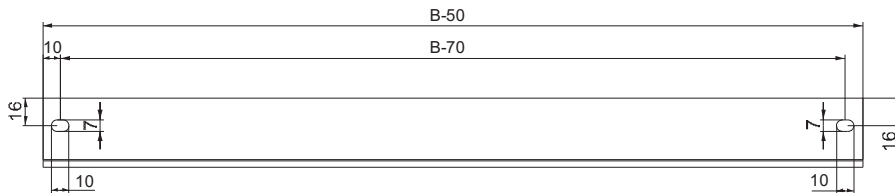

7

Cable management

Cable holding



Plastic cable support

- It clips or screws onto 35-mm symmetric rails or a C-shaped rail.
- Quick and easy fixing of cables using cable ties.

 Composition: 10 units.

 Reference by unit. Order by multiples of 10 (10, 20, 30...).

Width (mm)	Maximum no. of cables	Reference
75	5	NSYSCCDINLG75
140	9	NSYSCCDINLG140

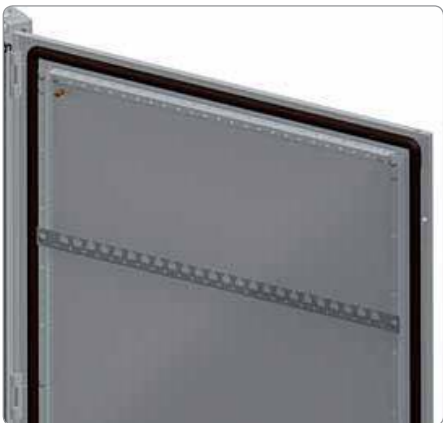
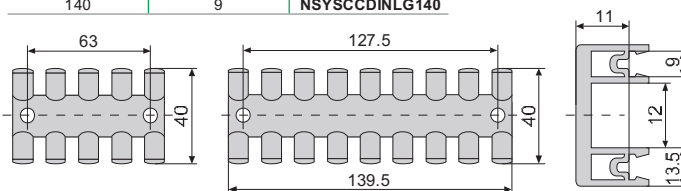

For ranges SF, SM, SFX, SMX

Door cable-guide cross-rail

- Recommended for fixing cables in the internal equipment of the door.
- Direct fixing on the reinforcement frame.
- Height adjustable every 25 mm.
- Material: zinc-coated steel.

 Composition: 2 cable-guide cross-rails and fixing elements.

Spacial dimensions (mm)	Reference
Width (B)	
500	NSYSDGCR5
600	NSYSDGCR6
800	NSYSDGCR8
1000	NSYSDGCR10

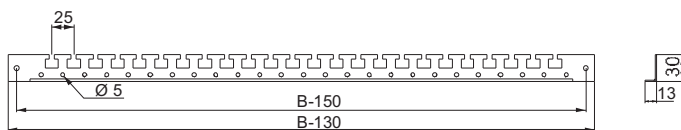

7



For ranges S3D, CRN, S3X

Door cable-guide cross-rails for wall-mounting enclosures

- They are installed on wall-mounting enclosures with heights from 400 mm for Spacial S3D/CRN and 500 mm for Spacial S3X.
- They are fixed to the door reinforcement frame by 2 self-tapping screws. The angle can be directed towards the body of the enclosure or towards the door.
- They make it easy to equip the inside of the door.
- Installation cable ties, page 7/116.

 Composition: 2 cable-guide cross-rails and fixing elements.

Door width (mm)	Reference
400	NSYTFPCR4
500	NSYTFPCR5
600	NSYTFPCR6
800	NSYTFPCR8
1000	NSYTFPCR10

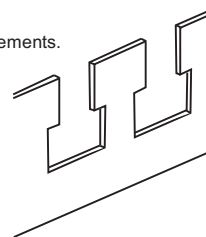

Cable management

Cable holding



Adjustable cable tie

- Polyamide 6/6.
- Operation temperature: -40 ... +85 °C.
- Melting point: 250 °C.
- Flame resistance according to UL 94 V-2.
- Glow-wire resistance at 650 °C / 30 s.
- Not sensitive to engine oil, greases, oil products, etc.
- Good resistance to bases and organic acids, chlorinated solvents. Not resistant to phenol.



Composition: 1000 units.



Reference by unit. Order by multiples of 1000 (1000, 2000, 3000...).

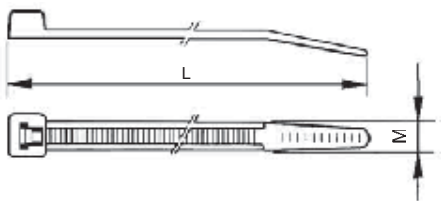

Width (mm)	Length (mm)	Maximum tightening Ø (mm)	Minimum resistance to pulling (kg)	Reference	
				Colourless	Black
2.5	100	18	8.2	NSYLZ25100	NSYLN25100
2.5	200	50	8.2	NSYLZ25200	NSYLN25200
3.5	200	49	8	-	NSYLN35200
3.6	140	33	13.6	NSYLZ35140	NSYLN35140
3.6	200	50	13.6	NSYLZ35200	NSYLN35200
3.6	295	76	13.6	NSYLZ35290	NSYLN35290
4.6	150	36	22	NSYLZ48160	NSYLN48160
4.6	390	109	22	NSYLZ48390	-
4.8	200	50	22.7	NSYLZ48200	NSYLN48200
4.8	270	73	22.7	NSYLZ48280	NSYLN48280
7.6	368	102	54.5	NSYLZ76380	NSYLN76380

7



Captive clips

They allow cable ties from series LZ25100 to LZ46390 to be fixed on panels with thicknesses of up to 3.2 mm. Material: 6.6 nylon.



Composition: 100 units.



Reference by unit. Order by multiples of 100 (100, 200, 300...).

Drill-hole Ø, mm	Max. panel thickness, mm	Figure	Reference
6	3.2	1	NSYSFC1

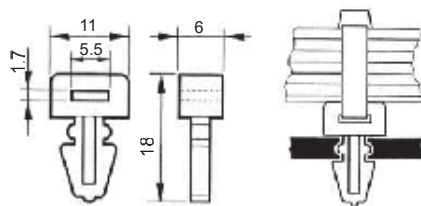

Fig. 1

Cable management

Cable holding



Cable-tie fixing support

For the installation of one or two cable-ties with a single screw. Material: 6.6 nylon. Compatible with the entire range of cable ties.

Composition: 100 units.

Reference by unit. Order by multiples of 100 (100, 200, 300...).

A	B	C	Fixing screw	Acceptable cable-tie width	Reference
12	18	9	M4	2.5 ÷ 4.8	NSYKR6
14.5	25	12	M6	2.5 ÷ 7.6	NSYKR8

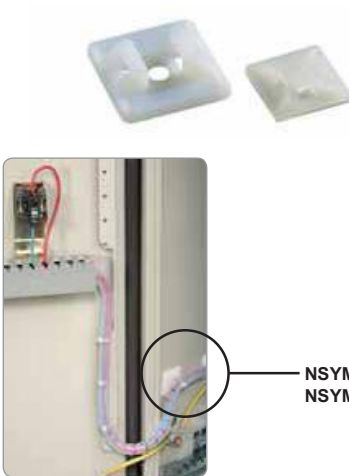
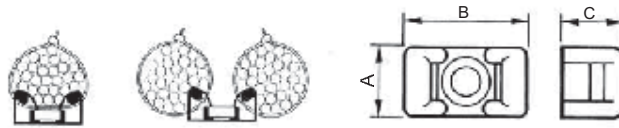

Self-adhesive support bases

• Material: colourless 6/6 polyamide.

Composition: 100 units.

Reference by unit. Order by multiples of 100 (100, 200, 300...).

H (mm)	W (mm)	D (mm)	Fixing screws	Reference
6	19	19	3.6	NSYMB3A
8	26.5	26.5	4.8	NSYMB4A

NSYMB3A/
NSYMB4A

Cable management

Cable distribution



Corrugated cable-gland tube

- Corrugated tube allowing cables to pass between the structure and the door.
- Free from halogens and heavy metals.
- UV protection.
- Material: low-density polyethylene (LDPE), black.

 Supply: one 25-m reel.

Nominal diameter (mm)	Inner Ø (mm)	Outer Ø (mm)	Reference
17	16.6	21.2	NSYCPT17
29	29	34.5	NSYCPT29
37	36	42.4	NSYCPT37
50	47.7	54.5	NSYCPT50



Fixing support for corrugated tube

- Fixing support for the corrugated tube, offering the following mounting options:
 - Directly on the enclosure.
 - On a swing 19" rack and/or cross rails, by means of a fixing point.
- The supports can be joined together to form sets of tubes, allowing better cable distribution.
- The support includes the base.
- It allows the tube to rotate once it has been fixed to the support and prevents the removal of the corrugated tube subject to a pulling force.
- Material: polyamide (PA), black.

 Supply: ten units and fixing elements.

 Reference by unit. Order by multiples of 10 (10, 20, 30...).

Model n Ø	Reference
17	NSYCPTS17
29	NSYCPTS29
37	NSYCPTS37
50	NSYCPTS50

n Ø = nominal diameter.

7



Cable management



Cable-gland for body/door

- Spiral strip for bundling cables.
- Allows cables to enter between the body and the door.



Supply: one 50-m reel.

Colour	Tightening range (mm)	Inner \varnothing (mm)	Outer \varnothing (mm)	Reference
Colourless	12 to 100	9	12	NSYTC12100

Cable management



Cable ducts with cover

- Rigid PVC material; with lateral through slots and rear perforations. Supplied in lengths of 2 m. RAL-7030 grey colour.
- Compliance with standards VDE 0660/506 and DIN 43659.
- Temperature resistance: -5 ... +60 °C.
- Behaviour in fire: material V0 according to UL 94.
- Fire resistance: 960 °C according to IEC 60695-2-1/1.
- Maximum capacity of H07.V.K 1.5-mm² flexible wire (filling factor: 0.6).

Dimensions (mm)			Composition (m)	Reference
Width	Height	Maximum capacity		
25	25	25	48	NSYCD2M2525
25	50	65	48	NSYCD2M2550
37.5	50	110	24	NSYCD2M3750
37.5	75	160	24	NSYCD2M3755
50	50	160	24	NSYCD2M5050
50	75	240	24	NSYCD2M5075
75	25	110	48	NSYCD2M7525
75	50	250	24	NSYCD2M7550
75	75	400	24	NSYCD2M7575
100	75	550	12	NSYCD2M10075
125	75	700	12	NSYCD2M12575



Covers for cable duct

- Replacement covers.
- Supplied in lengths of 2 m.

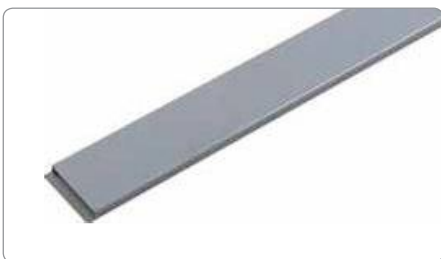

For cable duct	Composition (m)	Reference
25	48	NSYCDC2M25
37.5	24	NSYCDC2M37
50	24	NSYCDC2M50
75	24	NSYCDC2M75
100	12	NSYCDC2M100
125	12	NSYCDC2M125

7

Retention bars

- Fixed between 2 cable-duct slats by a hinged screw, preventing cable dropout.
- They can be cut to length to adapt to the width of the ducting.
- Material: flameproof high-impact polystyrene.



Supply: 50 units.



Reference by unit. Order by multiples of 50 (50, 100, 150...).

Reference

NSYCDRB

Cable management



For ranges
SF, SM, S3D, CRN,
PLA, S3X, SFX, SDX

Ø 22-mm cable-duct support

- Installed on the door of the wall-mounting or floor-standing enclosure associated with Ø 22-mm elements.
- Material: treated steel.

Supply: 10 units.

Reference by unit. Order by multiples of 10 (10, 20, 30...).

Reference
NSYSPCP

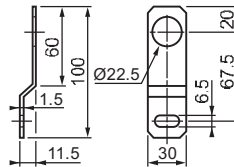

For ranges
SF, SM, SFX, SMX,
SD, SDX, PLA

Ducting support on technical upright

- Allows cable ducts to be installed on technical uprights, while increasing the usable surface of the equipment (up to 20% according to the width of the cable duct).
- Material: galvanised steel.

Supply: 10 units.

Reference by unit. Order by multiples of 10 (10, 20, 30...).

Reference
NSYCDS

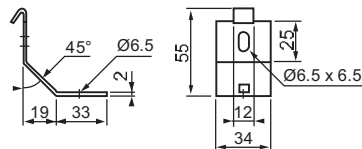

Cable management

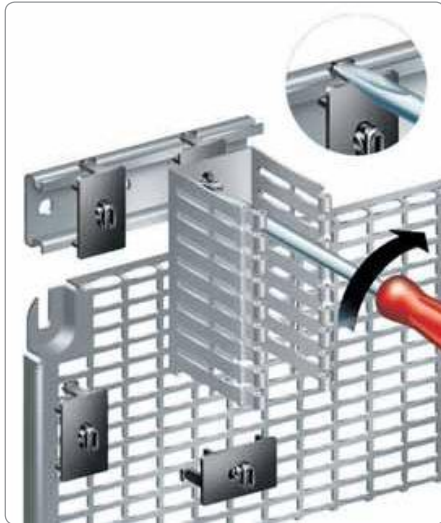

Plastic foot for cable-duct support

- Clips onto the Telequick mounting plate or the 35-mm DIN rail.
- Includes a bolt for fixing the cable ducts through the 6.5 × 14-mm drill holes made in the back.
- The 2 functions, clipping and bolting, provide considerable time savings.
- Material: black polyamide. Behaviour in fire: V0 according to UL 94.
- Respects electrical insulation.



Supply: 20 units.



Reference by unit. Order by multiples of 20 (40, 20, 60...).

Reference
NSYSPC



Label frame

- In transparent plastic, clipping onto the slats of the cable ducts. Paper labels supplied.
- Material: polycarbonate.



Supply: 50 units.



Reference by unit. Order by multiples of 50 (50, 100, 150...).

Reference
NSYCDL



Insulated-head screw

- M5 × 10-mm slotted hexagonal head.
- Respects electrical insulation.



Supply: 100 units.



Reference by unit. Order by multiples of 100 (100, 200, 300...).

Reference
NSYSM10M5HP

Cable management



Lyre-shaped clamps

- Clip-on clamps designed for direct installation on the 19" racks and Telequick mounting plates.



Supply: 10 units.



Reference by unit. Order by multiples of 10 (10, 20, 30...).

Reference

NSYGCR

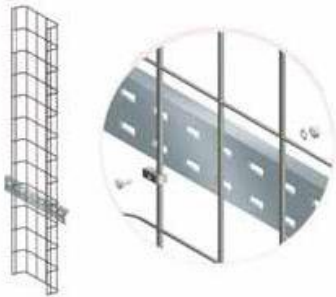

Steel wired cable tray

- Mounting on the cable supports.
- Made from zinc-coated steel wire.
- Dimensions (2 types):
 - 1845 × 200 × 35 mm.
 - 1845 × 200 × 54 mm.



Supply: 1 vertical steel wired cable tray and fixing elements.

Necessary depth (mm)	Reference
35	NSYBPC3
70	NSYBPC5

Accessories



Lighting and power socket

7/125

Electrical power distribution rails

7/125

Neon lamp E27 bulb base

7/126

Neon lamp

7/127

Ultra-flat lamp

7/128

Lamp for 1U 19" rack

7/128

Incandescent lamp

7/128

Lighting and power socket

Current distribution accessories



NSYAPU19F9



NSYAPU19F6CB



NSYAPU19F8S



NSYAPU19F7FA

Electrical power distribution rails

- Sockets positioned at 35°, 2P + E, AC 250 V 16 A/3680 W with child protection.
- UTE version according to NFC61314, IEC60884 and NBNC61112-1 standards.
- VDE version according to DIN49 440, VDE0620-1, IEC60884 and UNE20315 standards.
- Anodised-aluminium rail with a height of 1 U.
- Direct fixing to the 19" rack or framework uprights by stainless-steel brackets, supplied.
- Material: fibreglass polyamide plastic with fire resistance to 850 °C.
- 3-m power cord (3 × 1.5 mm²) type H05 VVF, equipped with an overmoulded 2P + E, 250 V, 10/16 A plug according to VDE0620-1, IEC60884, UNE20315 and NBNC61-112-1 standards.

Number of sockets	Width (mm)	Depth (mm)	Type	UTE	VDE
3	10"	44	A	NSYAPU10F3	NSYAPU10S3
3	10"	44	B	NSYAPU10F3S	NSYAPU10S3S
9	19"	44	A	NSYAPU19F9	NSYAPU19S9
8	19"	44	B	NSYAPU19F8S	NSYAPU19S8S
6	19"	76	C	NSYAPU19F6CB	NSYAPU19S6CB
7	19"	44	D	NSYAPU19F7FA	NSYAPU19S7FA
6	19"	44	E	NSYAPU19F6FT	NSYAPU19S6FT
6	19"	76	F	NSYAPU19F6F	NSYAPU19S6F
7	704	44	B	NSYAPUF7S	NSYAPUS7S
10	968	44	B	NSYAPUF10S	NSYAPUS10S
12	1232	76	C	NSYAPUF12CB	NSYAPUS12CB

- A: Rail of sockets without protection.
- B: Rail of sockets with recessed green LED switch.
- C: Rail of sockets with bi-polar magnetothermal circuit-breaker C16 type C60N 16 A curve C.
- D: Suppression filter for interferences of up to 30 MHz, nominal frequency 400 Hz, attenuation 20 dB per decade.
- E: Interference suppression filter and surge arrester, 6.5 kA short-circuit protection, protection level Up 1.5 kV, voltage test Uoc 5 kV Uc 255 V, 50 Hz. Operating LED, interferences of 30 MHz, nominal frequency 400 Hz, attenuation 20 dB per decade.
- F: Differential protection 30 mA, 2 poles 25 A NC type.



NSYAPUB



NSYAPUBV

Fixing brackets

- For vertical assembly of distribution rails.
- Batch of 2 brackets, adaptable to all rails, delivered with fixings.
- Material: treated steel, thickness 10/10 mm.
- Fixing to the ends of the rail: reference **NSYAPUBV**.
- Fixing with an orientation of 90°: reference **NSYAPUB**.

Fixing	Reference
Orientation of 90°	NSYAPUB
Ends of the rail	NSYAPUBV



NSYLAMDP



NSYLAMIN



NSYLAMPO

Neon lamp with E27 bulb base

- Available in three versions:
 - With motion sensor.
 - With On-Off switch.
 - Portable lamp with simple support, power cord and plugs.
- The references **NSYLAMDP** and **NSYLAMIN** allows the connection terminal for serial connection of a door switch and another lamp.

Designation	Reference	Fixation
Lamp with motion sensor	NSYLAMDP	Screws or magnetic*
Lamp with on/off switch	NSYLAMIN	
Portable lamp	NSYLAMPO	Adhesive

* It is impossible to fix it magnetically in stainless steel enclosures.

Technical characteristics

- Power consumption: 20 W.
- Voltage: 220 V / 50 – 60 Hz.
- Luminosity: 1000 Lm.
- Service life: 10000 h.
- Switch: Movement detector PIR, 3 min. lasting aprox.
- Connection: 4-pole screw connector 2.5 mm² (torque 0.5 Nm max.).
- Casing: Plastic according to UL94 V-0, light grey.
- Weight: Approx. 0.60 kg.
- Fitting position: Variable.
- Operating/Storage temperature: –20 to +50 °C (–4 to +122 °F) / –45 to +70 °C (–49 to +158 °F).
- Protection type/Protection class: IP20 / II (double insulated).
- According with the standard: IEC 55014 and IEC 50082-1.

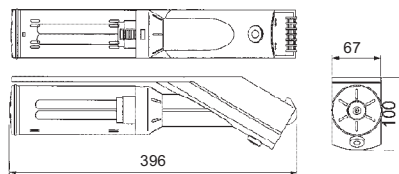

Accessories

- Separate power cord for ref. **NSYLAMDP** and **NSYLAMIN**.

Description	Reference
Power cord (1)	NSYCLAM

(1) Cord length: 2 m.

Lighting and power socket



Neon lamp

- Compact neon lamp, low consumption with switch and power socket.
- Magnetic fixing* or on a 35 mm DIN rail (non supply).
- Delivered with a protective glass.

* It is impossible to fix it magnetically in stainless steel enclosures.

Type of power socket	Luminosity	Power consumption	Voltage	Reference
UTE (16 A)	900 Lm	11 W	220/50 Hz	NSYLAM75UTE
VDE	900 Lm	11 W	220/50 Hz	NSYLAM75
BS (British Standard)	900 Lm	11 W	220/50 Hz	NSYLAM75BS
UL-CSA	700 Lm	9 W	115/60 Hz	NSYLAM75120
None	900 Lm	11 W	220/50 Hz	NSYLAC75

Technical characteristics

- Service life: 5000 h.
- Switch: Integrated.
- Connection: 3-pole screw connector 2.5 mm² (torque 0.5 Nm max.).
- Casing: Plastic light grey.
- Dimensions: 355 × 65 × 70 mm.
- Weight: Aprox. 1.0 kg.
- Fitting position: Variable.
- Operating/Storage temperature: -20 to +50 °C (-4 to +122 °F) / -45 to +70 °C (-49 to +158 °F).
- Protection type/Protection class: IP20.

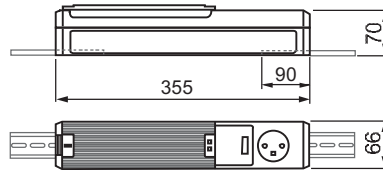



Ultra-flat lamp

- Plain and compact lamp of low consumption with 2G7 socket.
- Magnetic fixing* or by screw M5 (non supply).

* It is impossible to fix it magnetically in stainless steel enclosures.

Designation	Socket	Reference
Ultra flat lamp VDE	SCHUKO	NSYLAMS75
Ultra flat lamp UTE	-	NSYLAMS75UTE
Ultra flat lamp VDE	-	NSYLAMX75

Technical characteristics

- Power consumption: 11 W.
- Voltage: 220 V / 50 – 60 Hz.
- Luminosity: 900 Lm.
- Service life: 10000 h.
- Switch: Integrated.
- Connection: Screw connector 2.5 mm² (torque 0.8 Nm max.).
- Casing: Plastic according to UL94 V-0, light grey.
- Dimensions: 345 × 91 × 40 mm.
- Fitting position: Narrow surface/broad surface.
- Operating/Storage temperature: –20 to +50 °C (–4 to +122 °F) / –45 to +70 °C (–49 to +158 °F).
- Protection type/Protection class: IP20.

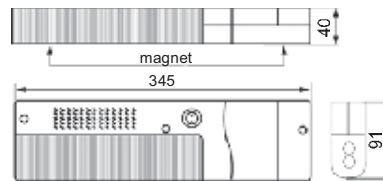

7



Lamp for 1 U 19" rack

- Compact neon lamp 11 W, 220 V/50 Hz with switch and power socket.
- Delivered with the fixings required for installation.
- Fixing on the 19" rack.

Type of socket	Reference
UTE	NSYLAM1UF
VDE	NSYLAM1US

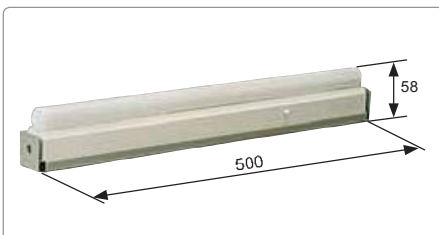

Incandescent lamp

- Incandescent lamp specifically designed for use in electrical enclosures.
- Connection voltage: 220 V/50-60 Hz.
 - Consumption: 60 W.
 - On/off switch.
 - Input connection terminal.

Reference
NSYLAJOL68

Accessories



Door accessories

7/130

Plastic and metal document pocket

7/130

Folding support tray

7/131

Door retainer

7/132

Door holding system

7/133

Door switch

7/134

Window for modular equipment IP 65

7/135

Plastic window IP 65

7/136

Acrylic window IP 65

7/137

Control protection frame IP 54

7/137

7

Door accessories



Plastic document pocket

- Fixing by adhesive tape.
- Formats: A5 and A4.
- Material: polystyrene (PS), RAL-7035 grey.



Supply: 1 plastic document pocket.

Document format (mm)	A	B	C	Reference
A5	174	188	22	NSYDPA5
A4	234	278	22	NSYDPA4
A4	234	278	40	NSYDPA44
A3	258	476	35	NSYDPA3

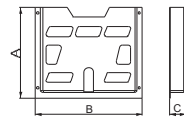

Metal document pocket

- Direct fixing on the door reinforcement frame.
- Height adjustable in steps of 25 mm.
- Material: steel.
- Finish: painted with epoxy-polyester resin, RAL-7035 grey.



Supply: 1 metal document pocket and fixing elements.

Enclosure dimensions (mm)	Reference
Width (B)	
600	NSYSDP6M
800	NSYSDP8M

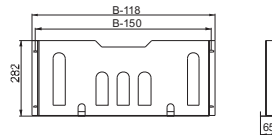

7

For ranges
SF, SM, **SFX**, **SMX**

Door accessories

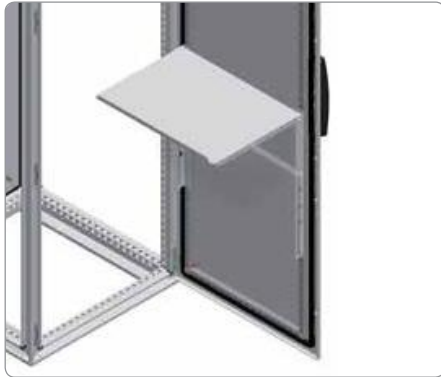

Folding support tray

- Adjustable horizontal support for laptop computers, documents or any other elements.
- Mounting on the door reinforcement frame.
- It can also be mounted on door cross-rails, see page 7/28.
- Height adjustable in steps of 25 mm.
- In 1000-mm-wide enclosures, any size can be mounted using door cross-rail ref. **NSYSDCR10**.
- 4 positions: 45°, 60°, 75° and 90°.
- Material: steel.
- Thickness: 1.5 mm.
- Finish: painted with polyester-epoxy resin, RAL-7035 grey.
- Maximum load: 30 kg.



Supply: 1 folding support tray and fixing elements.



Spacial dimensions (mm)	Reference
Width	
500	NSYSDT5
600	NSYSDT6
800	NSYSDT8

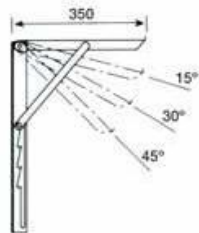

[For ranges
SF, SM, **SFX, SMX**]

Door accessories



[For ranges
SF, SM]

Door retainer

- Door blocker at the opening limit.
- It is fixed directly to the front frame of the enclosure and to the reinforcement frame of the door.
- It can be installed on doors that open both to the right and to the left.
- 2 versions:
 - Mechanical door stop, limit 105°.
 - Pneumatic door stop, limit 120°.



Supply: door stop and fixing elements.

Door stop model	Reference	For enclosures
Mechanical	NSYSFMDR	Spacial SF
	NSYSMDR	Spacial SM
Pneumatic	NSYSFNDR	Spacial SF
	NSYSMNDR	Spacial SM

Door accessories



Steel door retainer

For blocking the door at the end of its travel.

- It is installed on enclosures with heights from 400 mm and widths from 300 mm.
- Earthing connection of the enclosure by means of the reinforcement rail.
- Earthing accessories supplied with the enclosure (earth-connection wire to be ordered separately), see page 7/139.
- Warning: cannot be installed on 19" mounting plates or on enclosures equipped with internal door.

Description	Reference
Steel door retainer for Spacial wall-mounting steel enclosure	NSYAEDRSCST

[For ranges
S3D, CRN, CRNG]



Door-holding system

To hold the door open while working on the enclosure.

- It is installed on the perforated rails of the enclosure doors at the required height.
- Material: polyamide 6 (PA6).
- It is only installed on enclosures with a height of less than 400 mm (no perforated rails).
- It cannot be installed in the Spacial CRN enclosures.

Description	Reference
Door-holding system for Spacial wall-mounting steel enclosure	NSYAEDRS3DPA6

[For ranges
S3D, CRNG]



See also
the accessories

Support for cable ducting
with diameter 22
page 7/121

Door cable-guide
cross-rail
page 7/115

Door accessories



Door switch for floor-standing enclosures

- The switch is fixed to the structure of the enclosure.
- Drilled M20 cable entry for cable gland.
- NC + NO contact, 10 A/500 V.



Supply: 1 door switch and fixing elements.

Reference	For ranges
NSYDCM20	SF - SFX
NSYMDCM20	SM
NSYSNLPLA	PLA



Door switch for wall-mounting enclosures

- Switch/commutator unit equipped with support and fixings for direct fixing to the enclosure.
- Can be used to control lighting, air-conditioning units, etc.
- It is not compatible with installing the 19" swing rack and the internal door.
- NC + NO contact, 10 A/500 V.



Supply: 1 door switch and fixing elements.

Reference
NSYINLCRN

7

For ranges
CRN, S3D, S3X

Door accessories



Fig. 1



Fig. 2

Window for modular equipment, IP 65

They provide viewing and access to the inside of the enclosure while keeping the IP 65 protection degree. Made from transparent polycarbonate.



Supply: 1 window.

N.° of modules	Fig. n.°	A	B	C		Reference	
				Low cover	High cover	Low cover	High cover
2	1	78	60	15	25	NSYVA272M	NSYVA272MA
4	1	78	95	15	25	NSYVA274M	NSYVA274MA
6	1	78	130	15	25	NSYVA276M	NSYVA276MA
8	1	78	165	15	25	NSYVA278M	NSYVA278MA
10	1	78	200	15	25	NSYVA2710M	NSYVA2710MA
12	1	78	235	15	25	NSYVA2712M	NSYVA2712MA
16	2	195	165	13	-	NSYVA2716M	-
24*	2	196	235	13	-	NSYVA2724M	-
36*	2	248	235	13	-	NSYVA2736M	-
51**	2	248	325	13	-	NSYVA2751M	-

* In rows of 12 modules mounted vertically.

** In rows of 17 modules mounted horizontally.

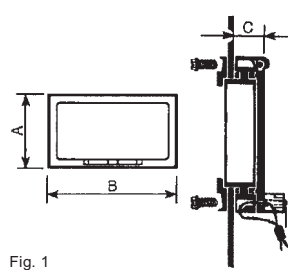

Fig. 1

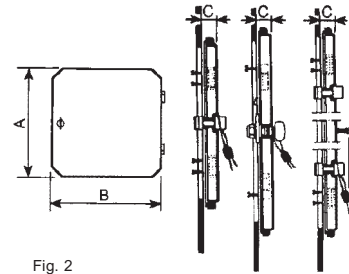

Fig. 2

Door accessories



Plastic window IP 55

- Plastic window with hinged cover for installation on front panel, IP 55.
- Polycarbonate cover and PVC body.
- External dimensions: 213 × 133 mm.
- Internal dimensions of the window: 180 × 78 mm.
- Delivered with a drilling template.



Composition: 1 plastic window.

Reference

NSYMW10M



Modular front panel with IP 55 sealed window

- Frame with transparent hinged cover for mounting modular switchgear on the front panel.
- Opening: 46 × 180 mm (10 modules).



Composition: 1 modular front panel.

Reference

NSYMW10MK



Kit for fixing the switchgear

- The fixing kit includes a DIN rail and its two supports.
- The unit is delivered assembled.



Composition: 1 DIN rail and two supports.

Reference

NSYMW10MR

7



Mounting example:
NSYMW10MK + NSYMW10MR

Door accessories



Acrylic window IP 55

- Transparent acrylic window, hinged, with gasket for installation on front panel. IP 55.
- Closure by lock with key n° 1242 E (2 locks for the height of 800 mm).
- Delivered with 2 hinges (3 for the height of 800 mm) and the fixings required for installation.
- Does not filter out UV.



Composition: 1 acrylic window, hinges, fixings and drilling template.

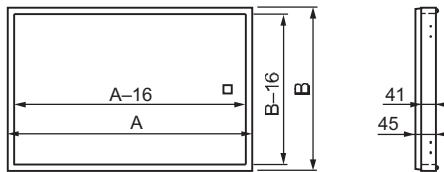

Acrylic window (mm)			Reference
A	B	Depth	
400	200	45	NSYAW24
400	400	45	NSYAW44
400	500	45	NSYAW54
400	600	45	NSYAW64
400	800	45	NSYAW84
500	200	45	NSYAW25
500	400	45	NSYAW45
500	500	45	NSYAW55
500	600	45	NSYAW65
500	800	45	NSYAW85
600	200	45	NSYAW26
600	400	45	NSYAW46
600	500	45	NSYAW56
600	600	45	NSYAW66
600	800	45	NSYAW86

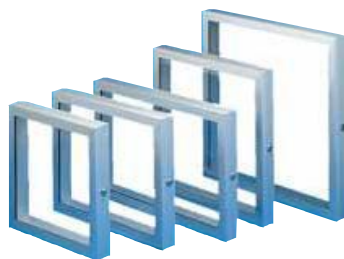

Control protection frame IP 54

- To prevent accidental handling of the control units by any unauthorised person.
- Allows all the displayed information to be read without opening the door.
- Construction: aluminium frame and Altuglas viewing window.
- Equipped with hinges for opening.
- Closure by a n° 1242 E lock, type 911 B Ronis.



Composition: 1 frame with window, hinges, fixings and drilling template.

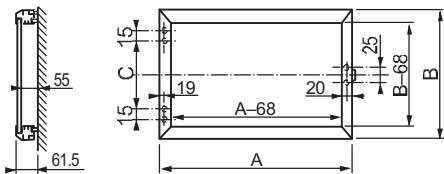

Door window (mm)			Reference
A	B	C	
400	400	220	NSYMA44
500	400	220	NSYMA45
600	400	220	NSYMA46
800	400	220	NSYMA48
500	500	320	NSYMA55
500	600	420	NSYMA56
600	500	320	NSYMA65
800	500	320	NSYMA58
600	600	420	NSYMA66

Accessories



Earthing accessories

7/139



Floor accessories

7/142



Paint accessories

7/144

7

Earthing accessories



Earth braids

- They guarantee the earth connection for high frequencies, avoiding the disturbing electric currents that are produced.
- Material: tinned copper.



Supply: 10 earth braids (nuts and washers not included).



Reference by unit. Order by multiples of 10 (10, 20, 30...).

Length (mm)	Width (mm)	Section (mm ²)	Terminal Ø (mm)	Reference
150	12	6	6.5	NSYEB156D6
150	17	10	6.5	NSYEB1510D6
155	17	16	8.5	NSYEB1516D8
200	27	25	8.5	NSYEB2025D8
200	33	50	8.5	NSYEB2050D8



Earth cables

- They make it easier to install a safe earth connection, with a perfect contact, with optimised length.
- Material: brass and copper alloy terminal, green and yellow PVC insulating sheath.



Supply: 10 earth cables (nuts and washers not included).



Reference by unit. Order by multiples of 10 (10, 20, 30...).

Length (mm)	Section (mm ²)	Terminal Ø (mm)	Reference
130	6	6.4	NSYEL136D6
160	6	6.4	NSYEL166D6
160	6	8.3	NSYEL166D8
170	10	6.4	NSYEL1710D6
220	6	6.4	NSYEL226D6
220	25	8.3	NSYEL2225D8
250	10	6.4	NSYEL2510D6
350	25	8.3	NSYEL3525D8

Earthing accessories

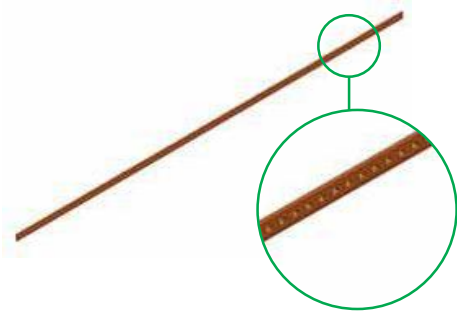

Earthing strip

- 15 × 3-mm perforated brass bar.
- 1 m long.
- 87 connection points, M5 drill holes.



Composition: 1 earthing strip and fixing elements.

Reference

NSYECB1M153



Central earthing point

- Connects earthing braids and cables to the structure of the enclosure.
- Fixing to the structure by means of self-tapping screws.
- The earth connection is made by means of the M8 × 18-mm bolt.



Supply: 1 central earthing point, elements for fixing to the structure, and fixings for fixing to the bolt.

Reference

NSYCEP

[For ranges
SF, SM, SFX,
SMX, SD, SDX]

Earthing accessories

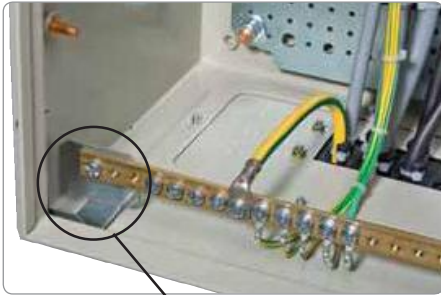

NSYEDCOS

[For ranges
S3D, S3X, CRN]

Fixing lugs for the earthing strip

- They allow the mounting of an earth-collector rail or a DIN rail at the top and bottom of an enclosure.
- Fixing on holes made in the gutter of the enclosure.
- Mounting incompatible with certain accessories. Please consult us.
- Earthing strip, page 7/137.



Composition: 2 lugs and fixings.

Reference
NSYEDCOS

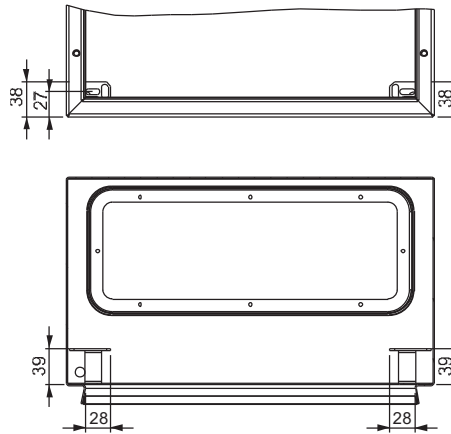

Floor accessories



For ranges
SF, SM, SD

Transport casters

- Set of 4 casters, 2 with a blocking system.
- Quick installation on plinths with heights of 100 and 200 mm, except the plinth for enclosure sets.
- They can be installed in front or side position.
- Clipping and fixing to the corner by screws.
- Maximum load: 100 kg per castor.
- For use on flat surfaces.
- Height: 110 mm.



Supply: 4 transport casters (2 with a blocking system) and fixing elements.

Reference
NSYSTW

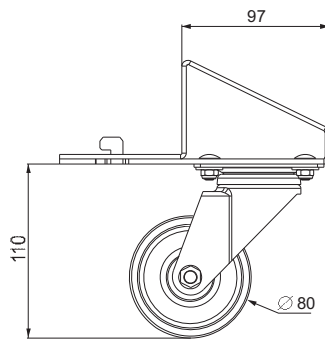

7



For ranges
SF, SM, SD,
SDX, SFX, SMX

Enclosure casters

- Set of 4 casters.
- Double casters.
- Maximum load: 160 kg per castor.
- Height: 92 mm.
- Diameter: 64 mm.



Supply: 4 casters and fixing elements.

Reference
NSYSW



Fixed feet.



Adjustable feet.

For ranges
SF, SM, SFX,
SMX, SD, SDX

Levelling feet (fixed and adjustable)

- Set of 4 floor feet.
- 2 models:
 - Fixed: height 42 mm.
 - Adjustable: height 22 mm.
- Material: steel.
- Maximum load: 100 kg per foot.

Levelling feet	
Model	Reference
Fixed feet	NSYSPSJ
Adjustable feet	NSYSRJ

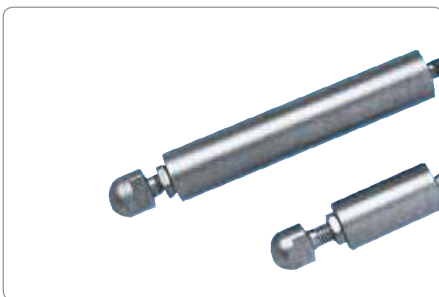

For ranges
SF, SM, SFX,
SMX, SD, SDX

Hygienic stainless-steel feet

- Set of 4 hygienic feet, made from 316L stainless steel, specific for harsh environments.
- Models:
 - Height: 100 mm.
 - Height: 200 mm.
- Height adjustment: 20 mm.
- Maximum load: 100 kg per foot.

 Supply: 4 feet.

316L stainless-steel hygienic feet	
Model with height (mm)	Reference
100	NSYPHX100
200	NSYPHX200

Paint accessories



For ranges
SM, SF, SD,
CRN, S3D, SDB

Aerosol paint can

- Air-drying paint.
- Content: 150 g.
- Colours: RAL 7035 and RAL 7032.

RAL	Reference
7032	NSYBPA7032
7035	NSYBPA7035



For ranges
SM, SF, SD,
CRN, S3D, SDB

Paint touch-up

- Paint for touching up with a brush.
- Air-drying.
- Colours: RAL 7035 and RAL 7032.

RAL	Reference
7032	NSYTUP7032
7035	NSYTUP7035

